

# ROYSTON & LUND



## Beech Avenue, Keyworth

£925 PCM

- Two Bedroom Bungalow
- Double Driveway and Single Garage
- Integrated Kitchen Appliances
- Freehold Council Tax Band - B
- Semi Detached
- Close By To Numerous Local Amenities
- Excellent Transport Links
- Spacious living room
- Enclosed Rear Garden
- EPC Rating - C

1 Victoria Road, Tamworth, Staffordshire, B79 7HL  
01827 66686

[tamworthenquiries@royston-lund.co.uk](mailto:tamworthenquiries@royston-lund.co.uk)  
[www.royston-lund.co.uk](http://www.royston-lund.co.uk)

# 81 Beech Avenue, Nottingham NG12 5DE

Royston and Lund are pleased to bring to the market this two bedroom semi detached bungalow located in Keyworth. Situated close by to numerous amenities that Keyworth has to offer such as local shops, pubs and cafes. Not to mention excellent transport links via the local bus service and being in the catchment area for well regarded schools. This property would be a great fit for a growing family or people wanting to downsize.

Interior accommodation has been fully refurbished throughout and comprises of a galley kitchen upon entry such as a oven, hob and extractor fan with room to fit further freestanding appliances. Moving through the kitchen you come into the generous size living room with a large front aspect window flooding the room with natural light, pieced together with an electric fireplace. Both bedrooms are doubles. The main bedroom having the benefit of built in storage space, the second bedroom granting access to the rear garden via French doors. Both bedrooms share a three piece bathroom consisting of a bath with shower overhead along with a wash basin and WC.

Facing the property there is ample off street parking due to a double driveway leading down to a single garage fitting several vehicles. The rear garden is a great size with a patio area to start stepping out from bedroom two leading onto a lawn space and further dropping down to further grass turf to the rear aspect. The rear garden is enclosed by fenced borders.



Council Tax Band: B







# Ground Floor

Approx. 66.0 sq. metres (709.9 sq. feet)

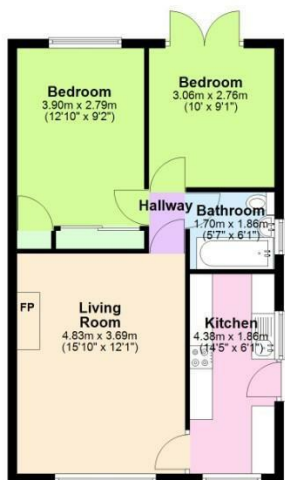

Total area: approx. 66.0 sq. metres (709.9 sq. feet)

## Viewings

Viewings by arrangement only. Call 01827 66686 to make an appointment.

## Council Tax Band

B

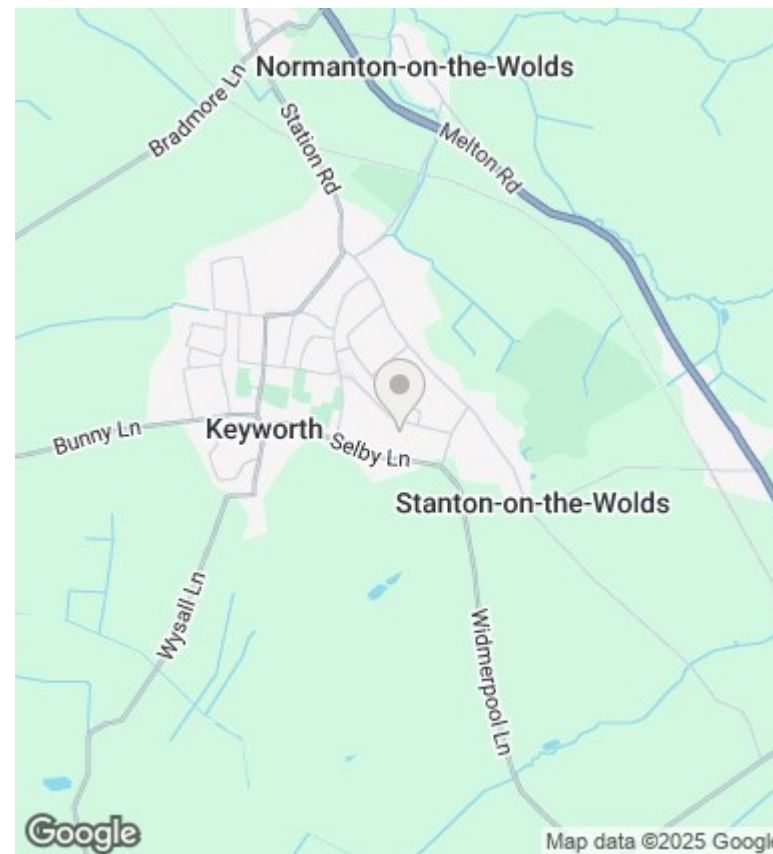

Energy Efficiency Rating		
	Current	Potential
Very energy efficient - lower running costs		
(92 plus) <b>A</b>		<b>87</b>
(81-91) <b>B</b>		
(69-80) <b>C</b>	<b>69</b>	
(55-68) <b>D</b>		
(39-54) <b>E</b>		
(21-38) <b>F</b>		
(1-20) <b>G</b>		
Not energy efficient - higher running costs		
England & Wales		EU Directive 2002/91/EC