



30 Tithebarn Drive

| DE12 6NX | Guide Price £160,000 - £165,000

ROYSTON
& LUND

- Guide Price £160,000 - £165,000
- Ample Size Kitchen / Diner
- Integrated Kitchen Appliances
- Detached Enclosed Garden
- Council Tax Rating - A
- One Bedroom Semi-Detached
- Fitted Wardrobes
- Designated Parking
- EPC Rating - B
- Freehold





Guide Price £160,000 - £165,000

Royston & Lund are delighted to present this one-bedroom semi-detached home.

Coming through the front hallway, to your left, the generously sized double bedroom features fitted wardrobes, providing ample built-in storage while maintaining a clean, uncluttered look. Directly ahead lies the ground floor bathroom, complete with modern fittings and a fresh, neutral décor.

Also on the ground floor, you'll find understairs storage, ideal for coats, shoes, or household essentials.

Upstairs, the property opens up. The first floor boasts a bright, open-plan kitchen-diner-living room, offering a versatile space perfect for both relaxing and entertaining. The modern kitchen is stylishly finished and includes integrated appliances, maximising convenience and functionality. Additional built-in storage on this level ensures every inch of space is well utilised.

Outside, while the garden is separate from the main property, it offers a private green space for outdoor enjoyment and relaxation. The home also benefits from designated parking.

*The maintenance charge is currently £277.30 per year which is paid via 2 payments every six months

Ground Floor

Approx. 24.0 sq. metres (258.1 sq. feet)

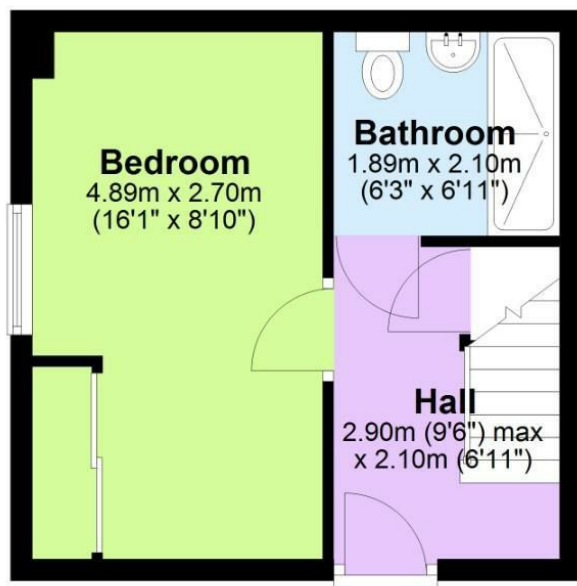

First Floor

Approx. 24.7 sq. metres (266.2 sq. feet)

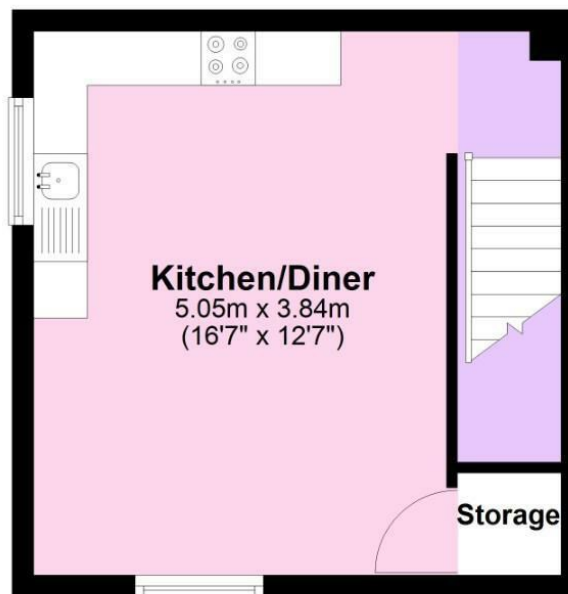

Total area: approx. 48.7 sq. metres (524.3 sq. feet)



EPC

Energy Efficiency Rating		
	Current	Potential
Very energy efficient - lower running costs		
(92 plus) A		98
(81-91) B	82	
(69-80) C		
(55-68) D		
(39-54) E		
(21-38) F		
(1-20) G		
Not energy efficient - higher running costs		
England & Wales EU Directive 2002/91/EC		
Environmental Impact (CO ₂) Rating		
	Current	Potential
Very environmentally friendly - lower CO ₂ emissions		
(92 plus) A		
(81-91) B		
(69-80) C		
(55-68) D		
(39-54) E		
(21-38) F		
(1-20) G		
Not environmentally friendly - higher CO ₂ emissions		
England & Wales EU Directive 2002/91/EC		

These particulars, whilst believed to be accurate are set out as a general outline only for guidance and do not constitute any part of an offer or contract. Intending purchasers should not rely on them as statements of representation of fact, but must satisfy themselves by inspection or otherwise as to their accuracy. No person in this firm's employment has the authority to make or give any representation or warranty in respect of the property.

**ROYSTON
& LUND**