



49 Clifton Avenue

| LE65 2HD | Guide Price £210,000

ROYSTON
& LUND

- Guide Price £210,000 to £220,000
- Substantial Living Room Space
- Large than Average South-West Facing Garden
- Short Walk into Ashby-de-la-Zouch
- EPC Rating - D
- Three Bedroom Semi-Detached
- Modern Fitted Kitchen Space
- Potential for Extension
- Freehold
- Council Tax Band - B





Guide Price £210,000 to £220,000

This charming three-bedroom semi-detached home offers generous living space, practical features, and exciting potential—all within walking distance of the vibrant market town of Ashby-de-la-Zouch.

As you step inside, you're greeted by a welcoming hallway with built-in storage, perfect for keeping shoes, coats, and everyday essentials neatly tucked away. From here, the home opens into a substantial living room, offering plenty of space for relaxing, hosting, or family time.

To the rear, the kitchen diner provides a sociable hub for everyday meals and gatherings, with direct access through the back door to a truly expansive south-west facing garden. Bathed in afternoon and evening sun, this outdoor space is ideal for summer entertaining, gardening, or simply enjoying the fresh air. It also offers excellent potential for extension (subject to planning), allowing you to tailor the home to your future needs.

Downstairs is a conveniently located family bathroom, while upstairs you'll find three well-appointed bedrooms, each with a good layout and natural light—ideal for family living, guest rooms, or a home office.

Set in a peaceful residential area, this home enjoys the added benefit of being just a short walk into Ashby, with its array of shops, cafés, schools, and amenities. Whether you're a first-time buyer, growing family, or looking to invest in a home with potential, this property ticks all the right boxes.





EPC

Energy Efficiency Rating		
	Current	Potential
Very energy efficient - lower running costs		
(92 plus) A		
(81-91) B		
(69-80) C		
(55-68) D		
(39-54) E		
(21-38) F		
(1-20) G		
Not energy efficient - higher running costs		
	64	
England & Wales EU Directive 2002/91/EC		
Environmental Impact (CO ₂) Rating		
	Current	Potential
Very environmentally friendly - lower CO ₂ emissions		
(92 plus) A		
(81-91) B		
(69-80) C		
(55-68) D		
(39-54) E		
(21-38) F		
(1-20) G		
Not environmentally friendly - higher CO ₂ emissions		
England & Wales EU Directive 2002/91/EC		

ROYSTON
& LUND

Ground Floor

Approx. 40.8 sq. metres (438.9 sq. feet)

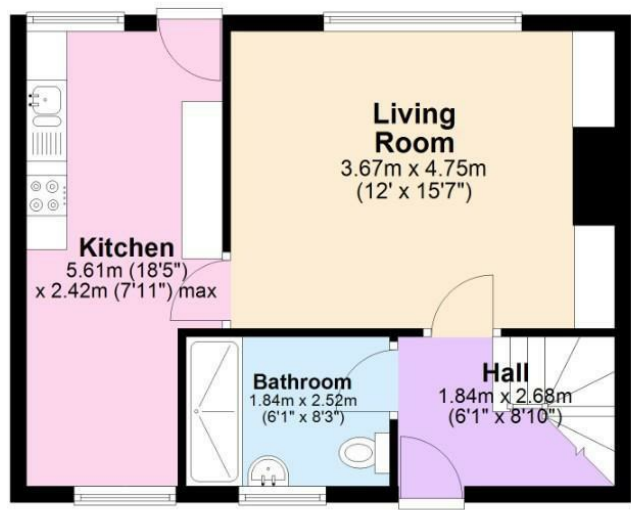

First Floor

Approx. 40.8 sq. metres (438.9 sq. feet)

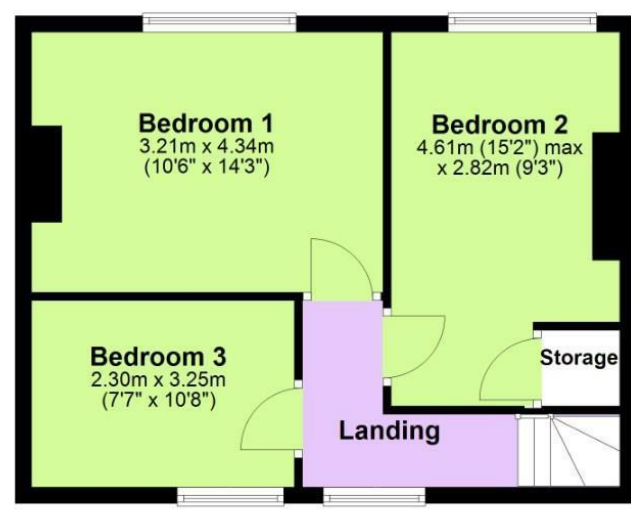

Total area: approx. 81.5 sq. metres (877.7 sq. feet)

These particulars, whilst believed to be accurate are set out as a general outline only for guidance and do not constitute any part of an offer or contract. Intending purchasers should not rely on them as statements of representation of fact, but must satisfy themselves by inspection or otherwise as to their accuracy. No person in this firms employment has the authority to make or give any representation or warranty in respect of the property.