



26 Main Street

| DE11 8AE | Guide Price £230,000 to £240,000

ROYSTON
& LUND

- Guide Price of £230,000 to £240,000
- Two/Three Bedroom Semi-Detached Bungalow
- Kitchen With Integrated Appliances
- Private Rear Garden
- Council Tax Band - B
- No Upward Chain
- Sizable Living Room
- Garage & Driveway
- EPC Rating - D
- Freehold





Guide Price £230,000 to £240,000 - No Upward Chain

Royston & Lund are delighted to present this well-presented semi-detached bungalow, offering comfortable single-level living with a thoughtful layout. Located in the quiet village of Blackfordby in the heart of the National Forest. The property offers versatile accommodation as either a two or three bedroom property.

Upon entering through the front door, you're welcomed directly into the kitchen, fitted with a range of wall and floor cabinet integrated appliances, and stylish spot lighting. Just adjacent, a spacious living room with a feature fireplace. A central hallway leads to three well-proportioned bedrooms, offering flexibility for family use. A dining room/bedroom has access to the garden. Completing the interior is the shower room.

Externally, the property benefits from its own driveway and front garden. To the rear, you'll find a private garden area, along with a link-detached garage providing excellent storage or additional parking.

Perfectly suited to those seeking single-storey living with style, this bungalow combines modern convenience with a practical layout in a desirable setting.



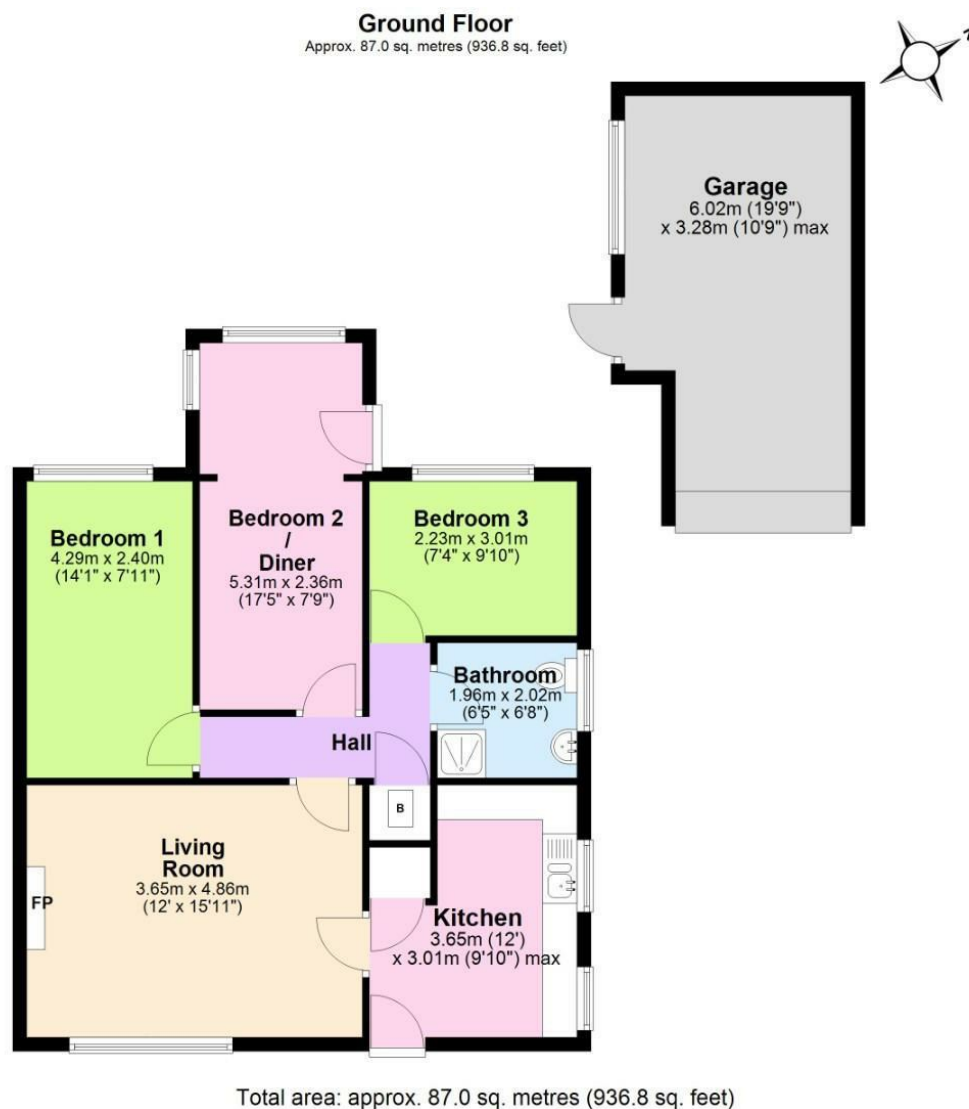

These particulars, whilst believed to be accurate are set out as a general outline only for guidance and do not constitute any part of an offer or contract. Intending purchasers should not rely on them as statements of representation of fact, but must satisfy themselves by inspection or otherwise as to their accuracy. No person in this firms employment has the authority to make or give any representation or warranty in respect of the property.



EPC

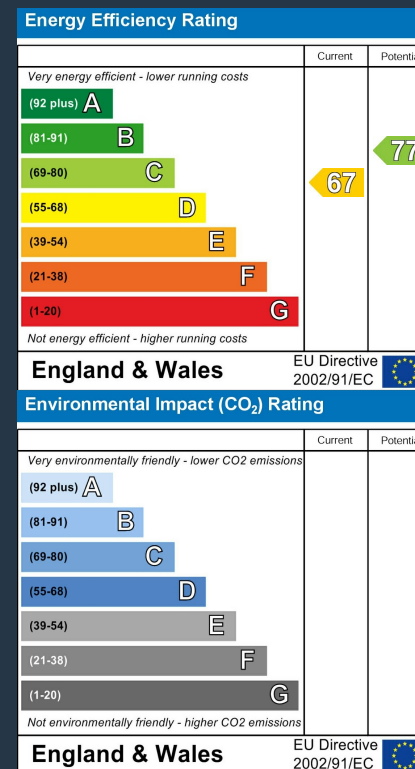

**ROYSTON
& LUND**