



7 Hall Street

| LE67 6JD | Guide Price Guide Price of £180,000 - £190,000

ROYSTON  
& LUND



- Guide Price of £180,000 - £190,000
- Kitchen with Induction Hob
- Bathroom
- Off-Street Parking
- Council Tax Band - A
- Two Bedroom Semi-Detached
- Living Room
- Detached Garage
- EPC Rating - D
- Freehold







Guide Price of £180,000 - £190,000

Royston and Lund are delighted to present this two-bedroom semi-detached home.

On entering through the front door, you are welcomed into the living room that flows directly into the kitchen which is fitted with an oven and induction hob.

From here, there is access to the rear garden, which is designed with a mix of slabbed patio, astro turf, and soil borders.

The property has side access to a detached garage, large enough to accommodate up to two vehicles.

Upstairs, you'll find two well-proportioned bedrooms and a bathroom featuring a shower-over-bath combination.

To the front, a generous driveway provides parking for multiple cars.



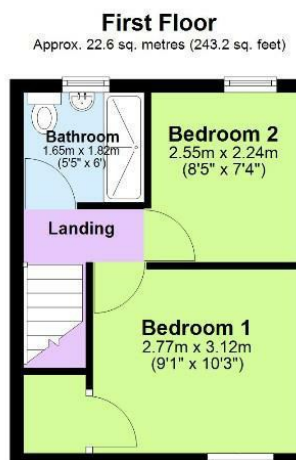
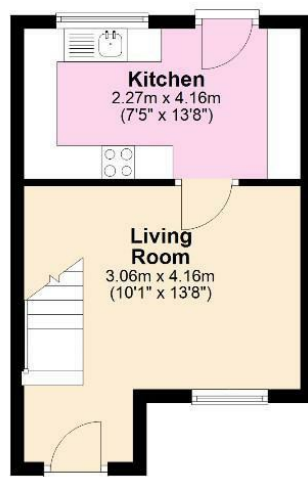
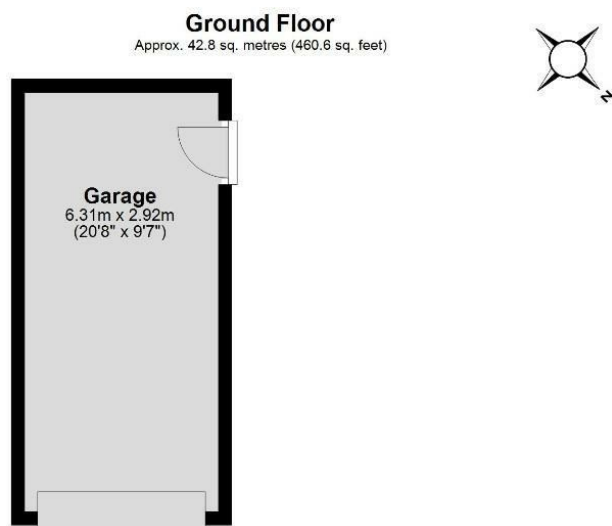

Total area: approx. 65.4 sq. metres (703.8 sq. feet)



**EPC**

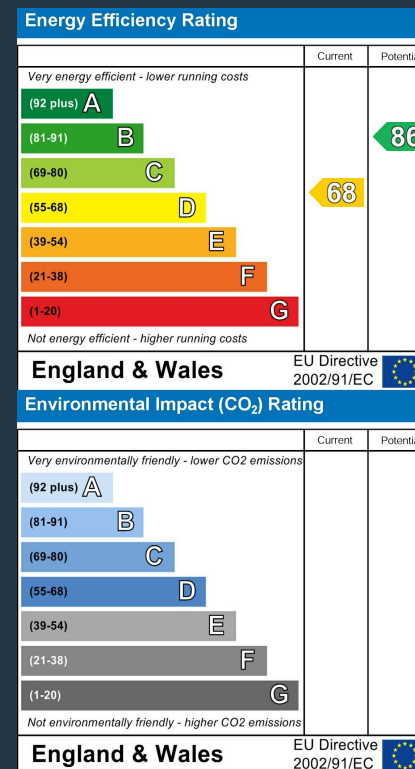

These particulars, whilst believed to be accurate are set out as a general outline only for guidance and do not constitute any part of an offer or contract. Intending purchasers should not rely on them as statements of representation of fact, but must satisfy themselves by inspection or otherwise as to their accuracy. No person in this firm's employment has the authority to make or give any representation or warranty in respect of the property.

**ROYSTON  
& LUND**