

# ROYSTON & LUND



## Saxon Mill Lane, Tamworth

£90,000

- One Bedroom Apartment
- Ample Size Living Room
- EPC Rating - C
- No Upward Chain
- Kitchen
- Council Tax Band - A
- Short Walk to Tamworth Town Centre
- Bathroom
- Service Charge - £963.49 for 6 months in Advance - Peppercorn Ground Rent

1 Victoria Road, Tamworth, Staffordshire, B79 7HL  
01827 66686

[tamworthenquiries@royston-lund.co.uk](mailto:tamworthenquiries@royston-lund.co.uk)  
[www.royston-lund.co.uk](http://www.royston-lund.co.uk)

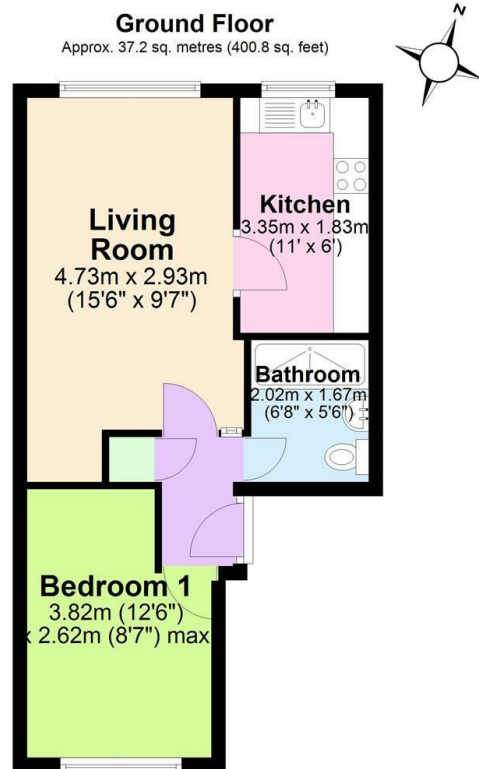

Total area: approx. 37.2 sq. metres (400.8 sq. feet)



## Directions

## Viewings

Viewings by arrangement only. Call 01827 66686 to make an appointment.

## Council Tax Band

A

## EPC Rating:

C

Energy Efficiency Rating		
	Current	Potential
Very energy efficient - lower running costs		
(92 plus) <b>A</b>		
(81-91) <b>B</b>		
(69-80) <b>C</b>	74	76
(55-68) <b>D</b>		
(39-54) <b>E</b>		
(21-38) <b>F</b>		
(1-20) <b>G</b>		
Not energy efficient - higher running costs		
<b>England &amp; Wales</b>	EU Directive 2002/91/EC	