



**6 Winster Grove, Worksop
S81 7QN**

Offers over £195,000

Located in a quiet cul-de-sac on Winster Grove, Worksop, this well-presented three-bedroom semi-detached home offers comfortable family living with a detached garage. The property benefits from recently fitted windows and doors, along with a modern, recently fitted bathroom. The ground floor features a bright lounge with understairs storage, leading through to a stylish kitchen/diner with access to the enclosed rear garden. Upstairs comprises three bedrooms and a family bathroom. Outside, the low-maintenance garden includes a porcelain patio and artificial lawn, ideal for relaxing or entertaining. Additional features include a side driveway with parking for two cars and a detached garage with lighting and electric.

- Semi Detached House
- Three Bedrooms
- Recently Fitted Windows And Doors
- Kitchen/Diner
- Cul De Sac Location
- Immaculately Presented Throughout
- Viewings Are Advised
- Detached Garage With Electric & Lighting

locating your ideal home



Ground Floor

Entrance Hall

A composite front door opens into the entrance hall, providing access to the lounge and stairs leading to the first floor.

Lounge

12'11" x 11'9" (3.96 x 3.6)

The lounge features a uPVC window to the front elevation, useful understairs storage, and a door leading through to the kitchen/diner.

Kitchen/Diner

14'11" x 8'11" (4.57 x 2.74)

The kitchen/diner is fitted with white gloss matching wall and base units, complemented by a granite-effect worktop. It includes a stainless steel sink and drainer, a gas hob with extractor above, an electric oven, and a built-in microwave. There is space and plumbing for a washing machine and space for a fridge freezer. A uPVC window overlooks the rear elevation, and a uPVC door provides access to the rear garden. The room is finished with tiled flooring.

First Floor

Bedroom One

11'8" x 8'5" (3.58 x 2.59)

Bedroom One features a uPVC window overlooking the front elevation and is fitted with a gas central heating radiator.

Bedroom Two

8'9" x 8'5" (2.69 x 2.59)

Bedroom Two includes a uPVC window to the rear elevation and is fitted with a gas central heating radiator.

Bedroom Three

8'7" x 6'2" (2.64 x 1.88)

Bedroom Three features a uPVC window to the front elevation and a gas central heating radiator. It is currently being used as a nursery.

Family Bathroom

The recently fitted family bathroom comprises an enclosed bath with a glass shower screen, a pedestal sink, and a low flush W/C. A uPVC obscure window to the rear elevation provides natural light, and the room is finished with tiled flooring.

Outside

Rear Garden

The fully enclosed rear garden offers a private and secure outdoor space, beautifully designed with a durable porcelain patio perfect for seating and entertaining. The low-maintenance artificial grass provides a vibrant green area all year round, while a convenient side gate allows easy access to the front of the property.

Front Elevation

The front elevation is predominantly laid to lawn on the right-hand side, creating a neat and welcoming appearance. To the side of the house, a driveway provides off-road parking and leads directly to the detached garage, which is equipped with electric power and lighting.



Tel: 01909 475111



locating your ideal home



Floor 0

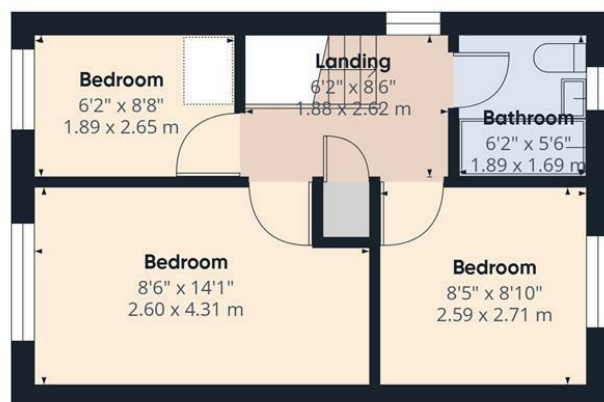

Floor 1

Approximate total area^m
652 ft²
60.7 m²

(1) Excluding balconies and terraces

Calculations reference the RICS IPMS 3C standard. Measurements are approximate and not to scale. This floor plan is intended for illustration only.

GIRAFFE360

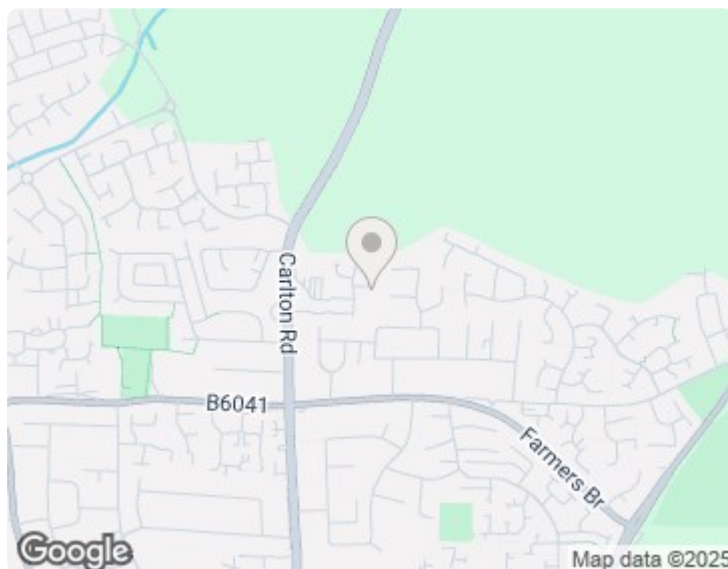
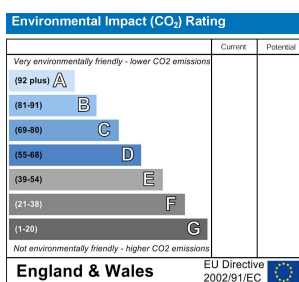
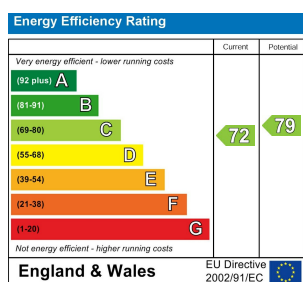

Important Notice: Prospective purchasers should note that these sales particulars have been prepared in good faith to give a fair overall view of the property and NOT as a statement of fact. Burrell's Estate Agents have not checked any services, appliances, equipment or facilities mentioned within these particulars and therefore cannot confirm them to be in working order. These sales particulars, including the description, photos and floorplans, are for guidance only and do not constitute part of an offer or contract.

You will be required to provide us with financial information in order to verify your position, before we can recommend your offer to the vendor. We will also require proof of identification in order to adhere to Money Laundering Regulations.

locating your ideal home

