



35 North Furzeham Road, Brixham, TQ5 8BB  
Freehold House - Terraced  
£450,000

**boyce**brixham  
email [property@ljboyce.co.uk](mailto:property@ljboyce.co.uk) call 01803 852736

A rare opportunity to acquire a truly substantial and deceptively spacious period residence occupying an elevated position on sought-after North Furzeham Road, with commanding, uninterrupted views across Brixham Harbour, the Breakwater, and the wider expanse of Tor Bay.

Currently arranged as two self-contained dwellings – Four Seas and Four Decks – this unique property has been thoughtfully configured to operate independently as successful holiday lets, while still retaining the structure and layout to allow for straightforward reversion to an impressive single family home, if desired.

This highly flexible home is perfectly suited to extended family living, continued investment, or full reconfiguration, and enjoys some of the most exceptional sea and harbour views available in Brixham. To the rear, two private, low-maintenance patio terraces have been recently upgraded (April 2026) with high-specification glass balustrading, creating a sleek, contemporary finish that significantly enhances both the outlook and overall ambience. These beautifully improved outdoor spaces are perfectly positioned to maximise the stunning coastal panorama, ideal for al fresco dining or simply relaxing while watching the ever-changing marine scene.

This exceptional property presents a rare chance to secure a versatile and sizeable home in one of South Devon's most desirable harbourside locations. Whether retained as a successful investment, adapted for extended family occupation, or transformed into a magnificent single residence, the potential here is considerable.

Importantly, the existing layout also offers clear scope for reconfiguration into a substantial private dwelling of at least four bedrooms. For example, the current Four Seas lounge could be repurposed as an en-suite bedroom, with the kitchen reimaged as a generous bathroom, demonstrating the versatility of the accommodation without being overly prescriptive.

Beneath the upper patio, there is a large storage room, offering excellent scope for use as a garden room or outdoor kitchen if required. The property benefits from electric heating throughout and UPVC double glazing. While there is no allocated parking, ample on-street parking is readily available nearby.



- Deceptively Spacious House
- Incredible Harbour & Bay Views
- Two Sea View Patio Areas

- Currently Arranged As Two Dwellings
- Very Close To Town & Harbour
- Freehold / Council Tax Bands A & B



**boyce**brixham

email [property@ljboyce.co.uk](mailto:property@ljboyce.co.uk) call 01803 852736



**boyce**brixham

email [property@ljboyce.co.uk](mailto:property@ljboyce.co.uk) call 01803 852736

### Four Seas (Upper Dwelling)

Accessed via a ground-floor entrance hall at street level, a staircase rises to the first-floor accommodation, where a generous lounge/dining room enjoys superb harbour views through a large picture window with charming window seat. Adjacent is a well-appointed fitted kitchen offering ample cupboard and worktop space. A modern shower room and separate WC complete this level.

A further set of characterful cottage-style stairs leads to the second floor, where a spacious double bedroom with dressing area and built-in storage benefits from elevated sea views. The accommodation is bright, well-maintained, and ideally suited to both long-term and holiday use.

Council Tax – Band A | EPC – E

### Four Decks (Lower Dwelling)

Approached via its own private entrance, this immaculately presented home offers stylish open-plan living. The lounge/kitchen/diner is a welcoming, sociable space featuring modern cabinetry, integrated appliances, and comfortable dining space. Full-width sliding glass doors perfectly frame the outstanding sea views and open directly onto the upgraded rear patios, seamlessly blending indoor and outdoor living.

A central staircase with sleek glass balustrade leads to the upper floor, where two well-proportioned bedrooms are found: a contemporary master double with large bay window and integrated window seat, and a bright twin room. A beautifully appointed modern bathroom with walk-in shower and quality fittings completes the accommodation.

Council Tax – Band B | EPC – D



Council Tax Band: E



**boyce**brixham

email [property@ljboyce.co.uk](mailto:property@ljboyce.co.uk) call 01803 852736



**boyce**brixham

email [property@ljboyce.co.uk](mailto:property@ljboyce.co.uk) call 01803 852736

LOWER GROUND FLOOR  
363 sq.ft. (33.8 sq.m.) approx.

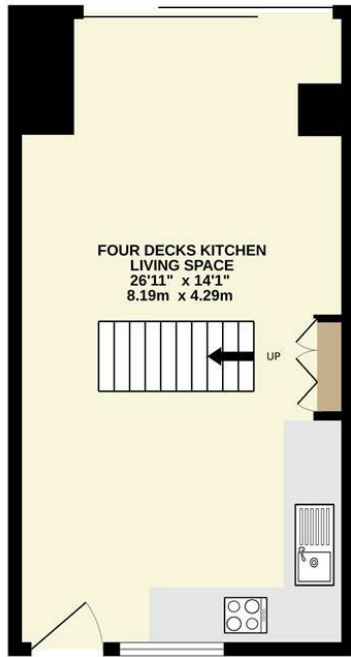

GROUND FLOOR  
384 sq.ft. (35.7 sq.m.) approx.

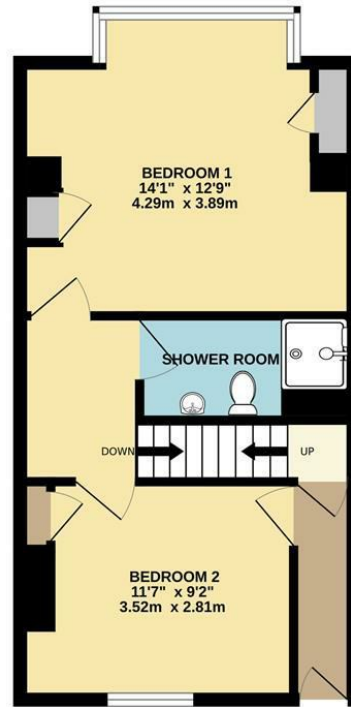

1ST FLOOR  
384 sq.ft. (35.7 sq.m.) approx.



2ND FLOOR  
168 sq.ft. (15.6 sq.m.) approx.



TOTAL FLOOR AREA : 1299 sq.ft. (120.7 sq.m.) approx.

Whilst every attempt has been made to ensure the accuracy of the floorplan contained here, measurements of doors, windows, rooms and any other items are approximate and no responsibility is taken for any error, omission or mis-statement. This plan is for illustrative purposes only and should be used as such by any prospective purchaser. The services, systems and appliances shown have not been tested and no guarantee as to their operability or efficiency can be given.  
Made with Metropix ©2025

Current EPC Rating: D

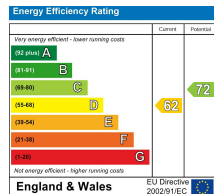

Find us on



Please note floorplans are to be used as a guide only. The Agent has not tested any apparatus, equipment, fixtures and fittings or services and so cannot verify that they are in working order or fit for purpose. A buyer is advised to obtain verification from their solicitor or surveyor. References to the tenure of the property are based on information supplied by the seller. The agent has not had sight of the title documents. A buyer is advised to obtain verification from their solicitor. You are advised to check the availability of this property before travelling distance to view.

**boyce**brixham

email [property@ljboyce.co.uk](mailto:property@ljboyce.co.uk) call 01803 852736