



7 Parkham Terrace, Wren Hill, Brixham, TQ5 9HU
Freehold House - Terraced
£210,000

boycebrixham
email property@ljboyce.co.uk call 01803 852736

Tucked away in a peaceful yet highly convenient position close to the heart of Brixham, this charming end-terrace freehold cottage presents a wonderful opportunity for those seeking a characterful coastal home. Perfectly suited as a first-time purchase, downsizing option, or indeed a delightful holiday retreat, the property enjoys a quiet setting whilst remaining only moments from the bustling harbour, waterfront cafes, shops and town centre amenities. Positioned towards the end of an attractive terrace of similar cottages, the home enjoys a lovely sense of privacy and charm from the outset.

One of the true highlights of this appealing cottage is the beautifully arranged outside space. To the front, a surprisingly spacious patio garden sits amongst the dappled light cast by the surrounding woodland, creating a peaceful spot to relax and enjoy the birdsong with a morning coffee or evening glass of wine. Despite the tranquil setting, the harbour and town centre are only a short stroll away, offering the best of both worlds. To the rear, the garden becomes even more impressive, enjoying a wonderfully sunny open aspect with a generous patio seating area leading to a raised deck and further terraced gardens beyond. A rear gate provides direct access to the road above where ample on-street parking can be found.

Approached from the front via a shared pathway running across the terrace, there is parking in the private road to the front of the property for residents only, on a first come first served basis, a particularly valuable feature for such a central location. Once inside, the cottage immediately showcases its warmth and character. The cosy living room, complete with an inset fireplace, is full of charm and creates an inviting atmosphere that perfectly complements the cottage style.

The living space flows naturally through into the kitchen area, creating a sociable open-plan layout ideal for modern living and entertaining alike. Unusually generous for a cottage of this nature, the kitchen offers excellent space for cooking, dining and gathering with friends and family, all while maintaining the home's welcoming feel. Light and airy throughout, the accommodation has been thoughtfully arranged to maximise both comfort and practicality.

On the first floor, the property continues to impress with a good-size double bedroom positioned to the front of the cottage, benefitting from fitted storage. A second bedroom sits to the rear alongside a modern family bathroom, while an inner hallway provides direct access out to the rear garden. Combining charm, practicality and a highly desirable tucked-away location close to Brixham's vibrant harbour, this neat little cottage is a property that simply should not be missed.

Council Tax Band: B



- Quiet tucked-away central location
- Ideal holiday home opportunity
- Charming freehold end-terrace cottage
- Open-plan living accommodation

- Rear access to parking nearby
- Spacious front patio garden
- Character lounge with inset fire
- Sunny terraced rear garden



boycebrixham

email property@ljboyce.co.uk call 01803 852736



boycebrixham
email property@ljboyce.co.uk call 01803 852736

TOTAL FLOOR AREA : 535 sq.ft. (49.7 sq.m.) approx.
 Whilst every attempt has been made to ensure the accuracy of the floorplan contained here, measurements of doors, windows, rooms and any other items are approximate and no responsibility is taken for any error, omission or mis-statement. This plan is for illustrative purposes only and should be used as such by any prospective purchaser. The services, systems and appliances shown have not been tested and no guarantee as to their operability or efficiency can be given.
 Made with Metropix ©2025

1ST FLOOR
 304 sq.ft. (28.2 sq.m.) approx.

GROUND FLOOR
 231 sq.ft. (21.5 sq.m.) approx.

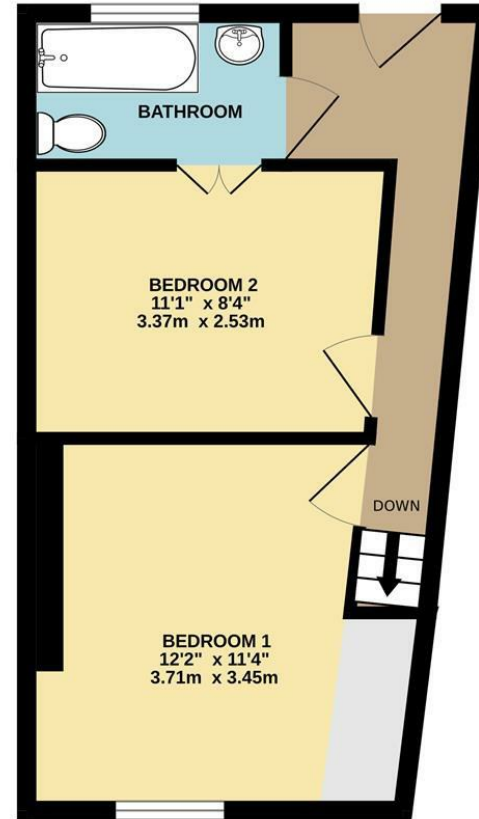

Current EPC Rating: D

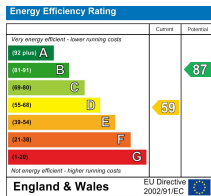

Find us on



Please note floorplans are to be used as a guide only. The Agent has not tested any apparatus, equipment, fixtures and fittings or services and so cannot verify that they are in working order or fit for purpose. A buyer is advised to obtain verification from their solicitor or surveyor. References to the tenure of the property are based on information supplied by the seller. The agent has not had sight of the title documents. A buyer is advised to obtain verification from their solicitor. You are advised to check the availability of this property before travelling distance to view.

boycebrixham

email property@ljboyce.co.uk call 01803 852736