



28 Hillcrest Drive, Longridge, Preston, PR3 3WU

£164,950

 3  1  2  D

This end terrace house is ideal for an investor or a first time buyer. In need of modernisation this lovely property is an exciting opportunity for someone to truly put their own stamp on it. The property comprises of an entrance porch, through a hallway which leads to a front living room, a rear dining room and a kitchen. Up the stairs to the first floor there are three bedrooms and a family bathroom. To the outside at the front is a gated entrance where there is a small pathway which leads to the front door and round the side of the house. To the rear is a private garden with an outhouse which is perfect for storage. Ideally located within walking distance of Longridge town and all facilities. Book your viewing today to avoid disappointment.













Road Map



Hybrid Map



Terrain Map



GROUND FLOOR
43.4 sq.m. (467 sq.ft.) approx.

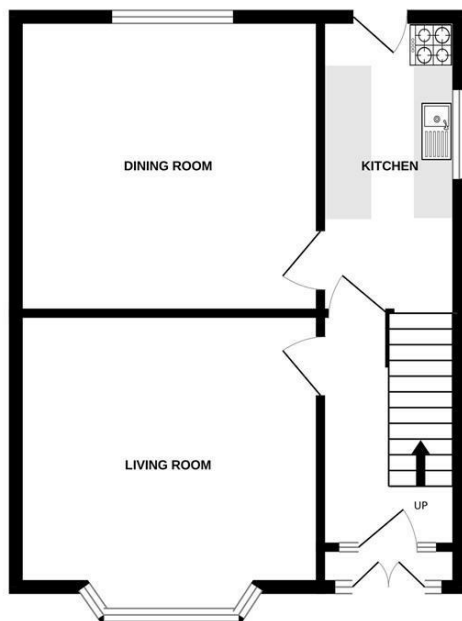

1ST FLOOR
43.4 sq.m. (467 sq.ft.) approx.

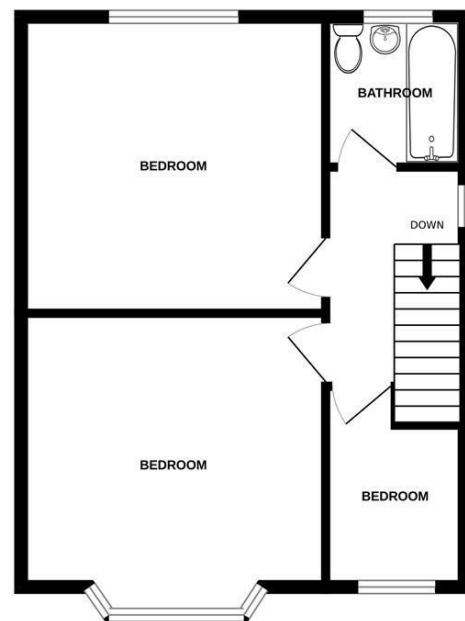

TOTAL FLOOR AREA : 86.8 sq.m. (934 sq.ft.) approx.
Every attempt is made to ensure accuracy, however all measurements are approximate. This plan is for illustrative purposes only and is not to scale.
Made with Metropix ©2024

Viewing

Please contact our Longridge Office on 01772 233380 if you wish to arrange a viewing appointment for this property or require further information.

Misdescriptions Act

These particulars, whilst believed to be accurate are set out as a general outline only for guidance and do not constitute any part of an offer or contract. Intending purchasers should not rely on them as statements of representation of fact, but must satisfy themselves by inspection or otherwise as to their accuracy. No person in this firm's employment has the authority to make or give any representation or warranty in respect of the property.