

The Drive

Hove

LEXTONS /
SALES
LETTINGS
AUCTIONS
COMMERCIAL



About the property

SOLD BY LEXTONS AUCTIONS

Auction Guide £115,000/£120,000

CASH BUYERS ONLY

Vacant one bedroom flat situated on the 4th floor of this sought after purpose built block with 43 years left on the lease in need of updating but having the benefit of a balcony leading directly from the lounge.

Marlborough Court is an established and extremely popular purpose built block of flats situated within this highly sought after location in the Drive, between Church Road and Cromwell Road close to all of the facilities Hove has to offer which include busses offering direct access to the city centre, local bars, restaurants, coffee shops, boutiques, Hove Mainline Railway Station, Sussex County Cricket Ground and Hove Seafront.

PLEASE SEE LETTER IN THE LEGAL PACK FROM THE FREEHOLDERS IN RESPECT OF THE LEASE EXTENSION WHICH PROVIDES FOR A MUCH REDUCED PREMIUM BEING AVAILABLE WHICH WILL ALSO TAKE THE LEASE UP TO A PERIOD OF 999 YEARS. PLEASE CONTACT THE AUCTIONEER FOR FURTHER INFORMATION.

The Drive Hove

£115,000



1

BEDROOM

1

RECEPTION

1

BATHROOM







SCAN HERE TO VIEW ALL AUCTION PROPERTIES



Fourth Floor

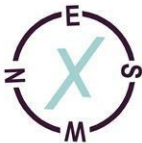
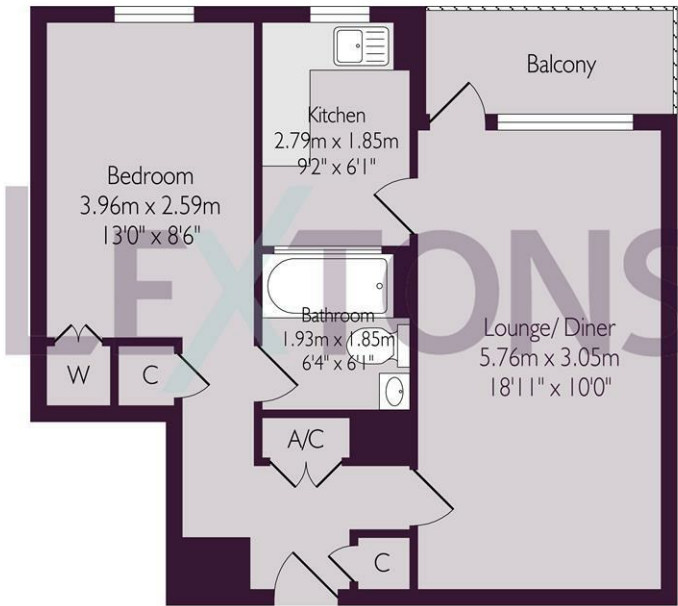

Approximate gross internal floor area 46.5 sq m/ 500.5 sq ft
Whilst every care has been taken to ensure accuracy, dimensions are approximate and for illustrative purpose only.
Created for Lextons. All rights reserved

Whilst every care has been taken to ensure accuracy, dimensions are approximate and for illustrative purposes only.

Created by Lextons. All rights reserved.

