

# 20 Seaside Eastbourne



## About the property

This charming flat which is a stones throw away from the beach welcomes you into a bright and spacious open-plan kitchen and living area — the perfect setting for both relaxation and entertaining. The modern kitchen is fully equipped, with ample storage and a sleek, contemporary design that blends seamlessly into the living space.

The property boasts a generous double bedroom with built-in storage, along with a well-appointed bathroom finished to a high standard.

Maintained throughout with care, this home is ideal for a single professional or couple seeking a stylish, comfortable, and private retreat in a highly convenient location.

Early viewing is strongly recommended.

# 20 Seaside Eastbourne

## £850 Per month



1

BEDROOM

1

RECEPTION

1

BATHROOM





SCAN HERE TO VIEW ALL AVAILABLE PROPERTIES

## Ground Floor

Approx. 36.1 sq. metres (388.7 sq. feet)

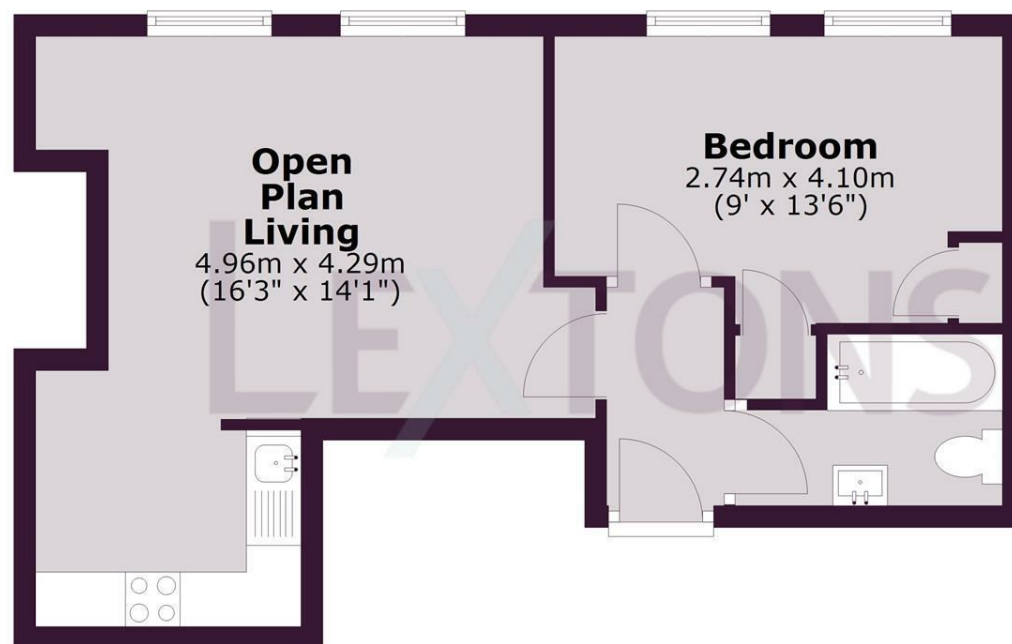

Total area: approx. 36.1 sq. metres (388.7 sq. feet)

Whilst every care has been taken to ensure accuracy, dimensions are approximate and for illustrative purposes only.

Created for exclusive use for Lextons. All rights reserved.

Plan produced using PlanUp.

Energy Efficiency Rating		
	Current	Potential
Very energy efficient - lower running costs		
(92 plus) <b>A</b>		
(81-91) <b>B</b>		
(69-80) <b>C</b>		
(55-68) <b>D</b>		
(39-54) <b>E</b>		
(21-38) <b>F</b>		
(1-20) <b>G</b>		
Not energy efficient - higher running costs		
<b>England &amp; Wales</b>	EU Directive 2002/91/EC 