

Syresham Gardens

Haywards Heath

LEXTONS /
SALES
LETTINGS
AUCTIONS
COMMERCIAL



About the property

This extremely well presented three bedroom mid-terrace house is located in the ever popular Haywards Heath and perfectly positioned to the local amenities of South Road.

Step inside and to the immediate right of the hallway you are greeted by a generously sized lounge diner which follows through to the kitchen, inclusive of white goods. The Southerly aspect garden with patio area can be accessed from here.

On the first floor there are two double bedrooms both with built in storage and a further single bedroom. There is also a beautifully refurbished bathroom with overhead shower attachment. The house also benefits from a single garage and driveway to the side of the property.

Syresham Gardens Haywards Heath

£1,700 Per month



3

BEDROOM

1

RECEPTION

1

BATHROOM



Ground Floor

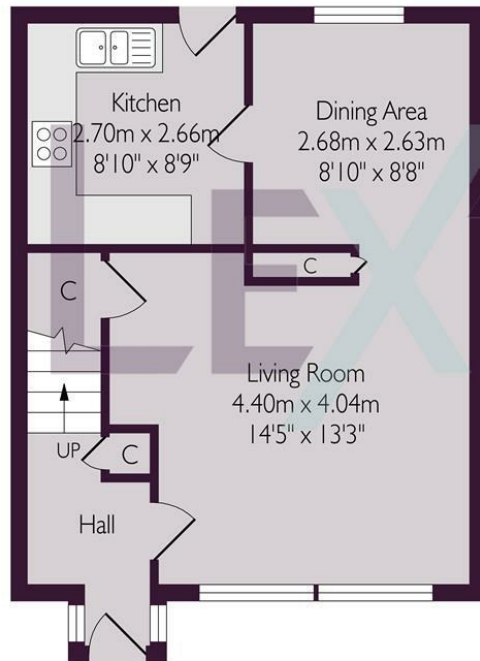

First Floor

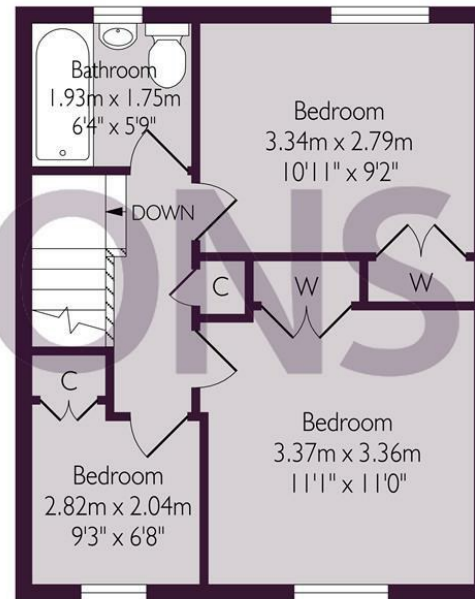

SCAN HERE TO VIEW ALL AVAILABLE PROPERTIES



Approximate gross internal floor area 74.6 sq m/ 803.0 sq ft

Whilst every care has been taken to ensure accuracy, dimensions are approximate and for illustrative purpose only.

Created for Lextons. All rights reserved

Energy Efficiency Rating		
	Current	Potential
Very energy efficient - lower running costs		
(92 plus) A		
(81-91) B		
(69-80) C		
(55-68) D		
(39-54) E		
(21-38) F		
(1-20) G		
Not energy efficient - higher running costs		
England & Wales	EU Directive 2002/91/EC	