

Richmond Terrace

Brighton

LEXTONS /
SALES
LETTINGS
AUCTIONS
COMMERCIAL



Richmond Terrace Brighton

£1,850 Per month

2

BEDROOM

1

RECEPTION

2

BATHROOM

About the property

A wonderful opportunity to live in one of the most beautiful buildings in Brighton, Old College House.

Old College House is located on Richmond Terrace opposite The Level, moments away from the hustle and bustle of North Laine, Brighton Station.

As you enter this unique apartment from the communal areas, Upon entering the property, the hallway leads to a generously sized reception room with an open plan kitchen area. There is plenty of space for dining and lounge areas, ideal for anyone who likes to entertain with its generous square footage and breathtaking vaulted ceilings. As well as the reception there is a modern family shower room.

On the mezzanine floor are two large gallery reception areas. The master bedroom has a walk-in wardrobe and an en-suite bathroom, whilst the second bedroom has plenty of space for any additional storage that may be required.

Old College House is located on Richmond Terrace, moments away from the hustle and bustle of North Laine, Brighton Station and plenty of green areas. The seafront is South of the property continuing on Richmond Terrace



SCAN HERE TO VIEW ALL AVAILABLE PROPERTIES



Second Floor



Third Floor

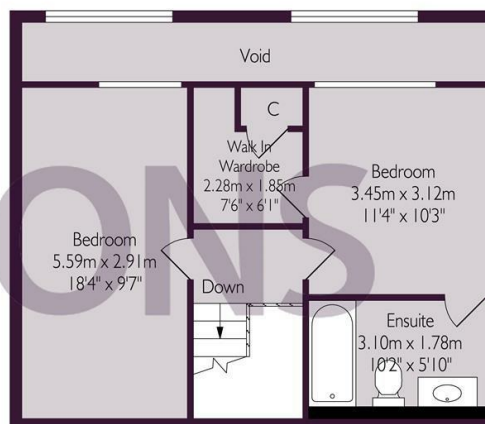
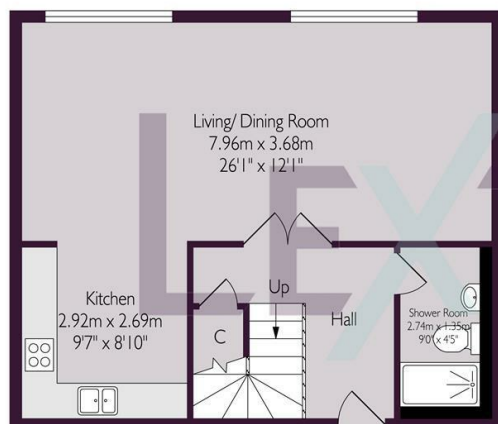

Approximate gross internal floor area 97.8 sq m/ 1053 sq ft

Whilst every care has been taken to ensure accuracy, dimensions are approximate and for illustrative purpose only.

Created for Lextons. All rights reserved

