

Seaside Eastbourne



About the property

This charming self-contained studio flat is ideally situated in central Eastbourne, just moments from the vibrant seafront and a short walk to local shops and amenities. The property boasts a well-designed open-plan living space, featuring a modern kitchen area equipped with essential appliances and ample storage. The flat includes a separate bathroom, offering a comfortable and private retreat.

Perfectly located for enjoying the best of Eastbourne, this studio provides both convenience and comfort, making it an excellent choice for those seeking a seaside lifestyle with everything on their doorstep.

Seaside Eastbourne

£700 Per month



null

BEDROOM

1

RECEPTION

1

BATHROOM



SCAN HERE TO VIEW ALL AVAILABLE PROPERTIES



First Floor

Approx. 20.1 sq. metres (216.9 sq. feet)

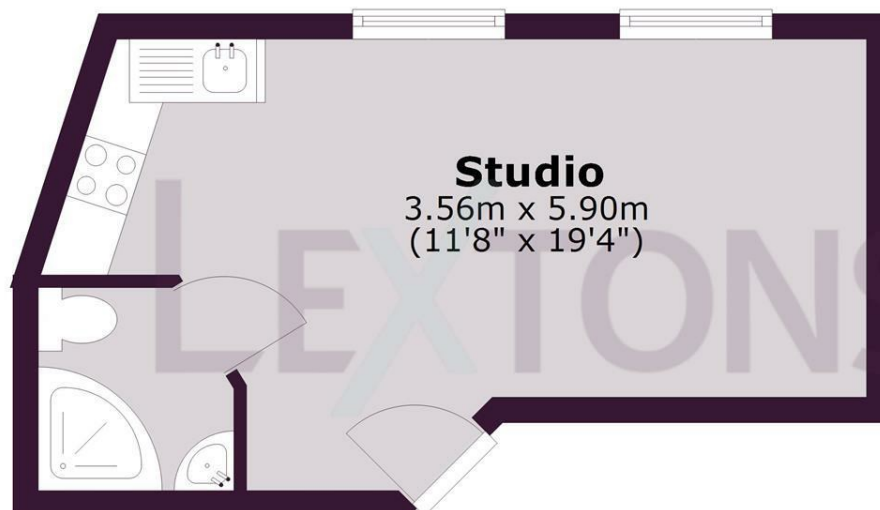

Total area: approx. 20.1 sq. metres (216.9 sq. feet)

Whilst every care has been taken to ensure accuracy, dimensions are approximate and for illustrative purposes only.

Created for exclusive use for Lextons. All rights reserved.

Plan produced using PlanUp.

Energy Efficiency Rating		
	Current	Potential
Very energy efficient - lower running costs		
(92 plus) A		
(81-91) B		
(69-80) C	72	72
(55-68) D		
(39-54) E		
(21-38) F		
(1-20) G		
Not energy efficient - higher running costs		
England & Wales		EU Directive 2002/91/EC