

Gladstone Terrace

Brighton



Gladstone Terrace Brighton

£1,500 Per month



2

BEDROOM

1

RECEPTION

1

BATHROOM

About the property

This well-proportioned two-bedroom first-floor flat is ideally situated in a central and highly sought-after area, within easy reach of numerous amenities including London Road railway station, The Level, and the vibrant Lewes Road shopping thoroughfare.

The accommodation comprises a generous living room, two good-sized bedrooms, a shower room, a separate WC, and a fitted kitchen complete with white goods and a door leading out to the shared garden.

Viewings are encouraged.





SCAN HERE TO VIEW ALL AVAILABLE PROPERTIES

First Floor

Approx. 50.9 sq. metres (547.8 sq. feet)

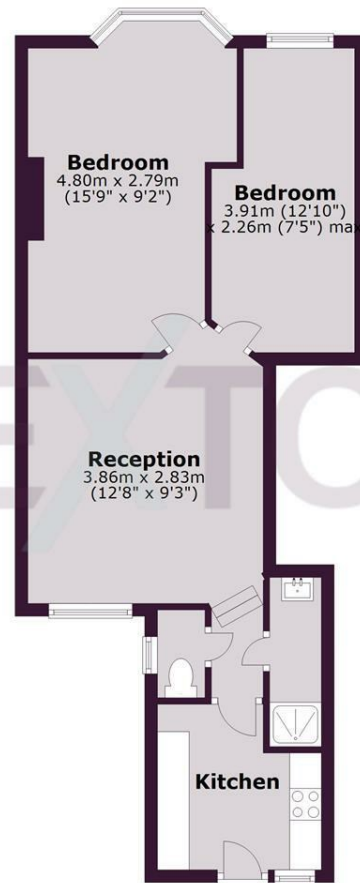

Total area: approx. 50.9 sq. metres (547.8 sq. feet)

Energy Efficiency Rating		
	Current	Potential
Very energy efficient - lower running costs		
(92 plus) A		
(81-91) B		
(69-80) C		
(55-68) D	64	78
(39-54) E		
(21-38) F		
(1-20) G		
Not energy efficient - higher running costs		
England & Wales	EU Directive 2002/91/EC	