

Brunswick Terrace

Hove



About the property

Set on one of Brighton and Hove's most desirable seafront parades, directly opposite Hove Lawns, this impressive first floor apartment blends period charm with exceptional coastal views. High ceilings and well-proportioned rooms create a bright and spacious feel throughout, while the standout lounge opens onto a private balcony with direct sea views — the perfect place to enjoy the ever-changing coastline.

The modern kitchen is fitted with a range of integrated Bosch appliances, including a dishwasher, washing machine, microwave, oven, hob and extractor, offering both style and practicality. There are two generous double bedrooms, with the principal bedroom benefiting from an en-suite, while a separate contemporary bathroom serves the remainder of the apartment.

Offered with no onward chain, this is an excellent opportunity to acquire a well-positioned seafront home within easy reach of local shops, cafés and transport links.

Brunswick Terrace Hove



2

BEDROOM

1

RECEPTION

2

BATHROOM









SCAN HERE TO OFFER ON THIS PROPERTY

First Floor
Approx. 81.1 sq. metres (873.5 sq. feet)
(excluding Balcony)

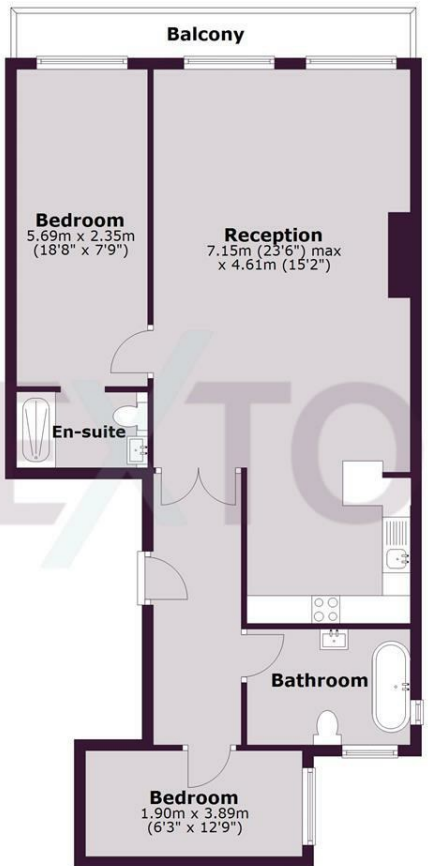

Total area: approx. 81.1 sq. metres (873.5 sq. feet)

Whilst every care has been taken to ensure accuracy, dimensions are approximate and for illustrative purposes only.
Created for exclusive use for Lextons. All rights reserved.
Plan produced using PlanUp.

Energy Efficiency Rating		Current	Potential
Very energy efficient - lower running costs			
(92 plus) A			
(81-91) B			81
(69-80) C	72		
(55-68) D			
(39-54) E			
(21-38) F			
(1-20) G			
Not energy efficient - higher running costs			
England & Wales		EU Directive 2002/91/EC	