

Rowan Close

Portslade

LEXTONS /
SALES
LETTINGS
AUCTIONS
COMMERCIAL



Rowan Close Portslade

£425,000- £450,000
Guide Price



3

BEDROOM

1

RECEPTION

2

BATHROOM

About the property

*** Guide price £425,000 to £450,000 ***

Welcome to this stunning three-bedroom semi-detached house, a contemporary gem nestled in the heart of Portslade, built in 2021 and immaculately maintained. As you step through the front door, you are greeted by a spacious hallway, setting the tone for the modern and comfortable living that awaits you.

The lounge is bathed in natural light from the south-facing windows, creating a bright and inviting space for relaxation and entertaining. The carefully designed layout seamlessly flows into the modern kitchen/diner, a hub for culinary creativity and social gatherings. The kitchen boasts sleek finishes and top-of-the-line appliances, complemented by a dining area that opens up to a generously sized garden - perfect for outdoor enjoyment and al fresco dining.

Convenience is key with the added benefit of a downstairs shower room, offering practicality and ease for both residents and guests. Moving upstairs, you'll find two spacious double bedrooms, each providing a comfortable retreat. Additionally, there's a well-proportioned single bedroom that could serve as a cozy guest room, home office, or child's space. The family-sized modern bathroom completes the upper level, featuring contemporary fixtures and finishes.

Parking is a breeze with off-road parking, ensuring your vehicle is secure and easily accessible. This property is not only a beautiful and contemporary residence but also strategically located in Portslade, offering easy access to local amenities, schools, and transportation links.

In summary, this three-bedroom semi-detached house combines modern design with practical functionality, creating a home that is both stylish and comfortable. Don't miss the opportunity to make this immaculate property your own and enjoy the best of contemporary living in Portslade.









SCAN HERE TO OFFER ON THIS PROPERTY

Ground Floor

Approx. 46.9 sq. metres (504.4 sq. feet)

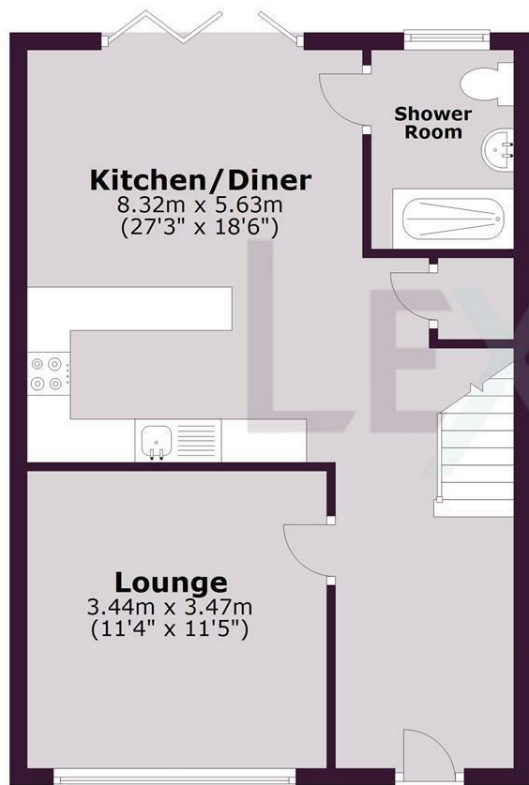

First Floor

Approx. 46.3 sq. metres (498.0 sq. feet)

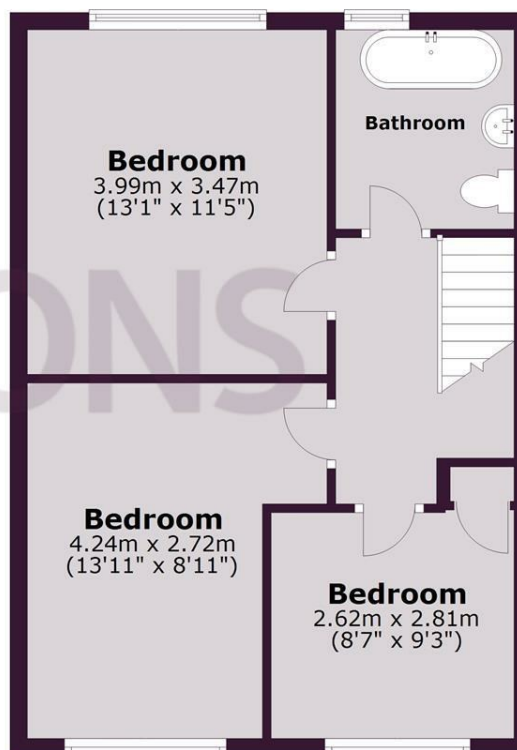

Total area: approx. 93.1 sq. metres (1002.4 sq. feet)

Energy Efficiency Rating		
	Current	Potential
Very energy efficient - lower running costs		
(92 plus) A		
(81-91) B		
(69-80) C		
(55-68) D		
(39-54) E		
(21-38) F		
(1-20) G		
Not energy efficient - higher running costs		
England & Wales	79	85
EU Directive 2002/91/EC		