

New Barn Close

Brighton





We know just the place...



Offers in excess of £450,000. A wonderful four-bedroom, terraced house with a large west facing garden, a garage and private driveway situated in Brighton. The property has been thoughtfully and contemporarily decorated throughout and offers a stunning landscaped, tiered garden. New Barn Close is well situated, close to a range of amenities including a Sainsbury's superstore and several great schools.

As you enter the property from the ground level a spacious hallway provides access to a large private garage and convenient utility cupboard. Rising to the first floor, you are welcomed into a generously sized, open plan kitchen/reception/dining room. The room has been neutrally and beautifully decorated in a modern style and features a lovely walnut floor throughout. The kitchen offers plenty of storage and counter top space as well as several integrated appliances. A large bay window at the front of the property and two sets of glass double doors at the rear allow the room to be flooded with light at all times of the day. From here there is access to the attractively designed rear garden, which has been carefully laid out to create an excellent space for both relaxing and entertaining during the summer months.

On the second floor, there are three good sized bedrooms each neutrally decorated and fitted with tasteful plantation shutters. There is also a spacious, modern family bathroom with separate shower cubicle and sumptuous roll top bathtub. On the third floor is a large master bedroom with contemporary en-suite shower room. The room is fitted with a wall of built-in wardrobes and features Velux windows with uninterrupted views over the city and the South Downs. A noteworthy point to mention about this property is the highly useful volume of storage space, an ideal addition to suit the needs of any modern-day family.

New Barn Close is hidden off Fox Way in Portslade. Portslade station the closest train link to London



4



2



1



D

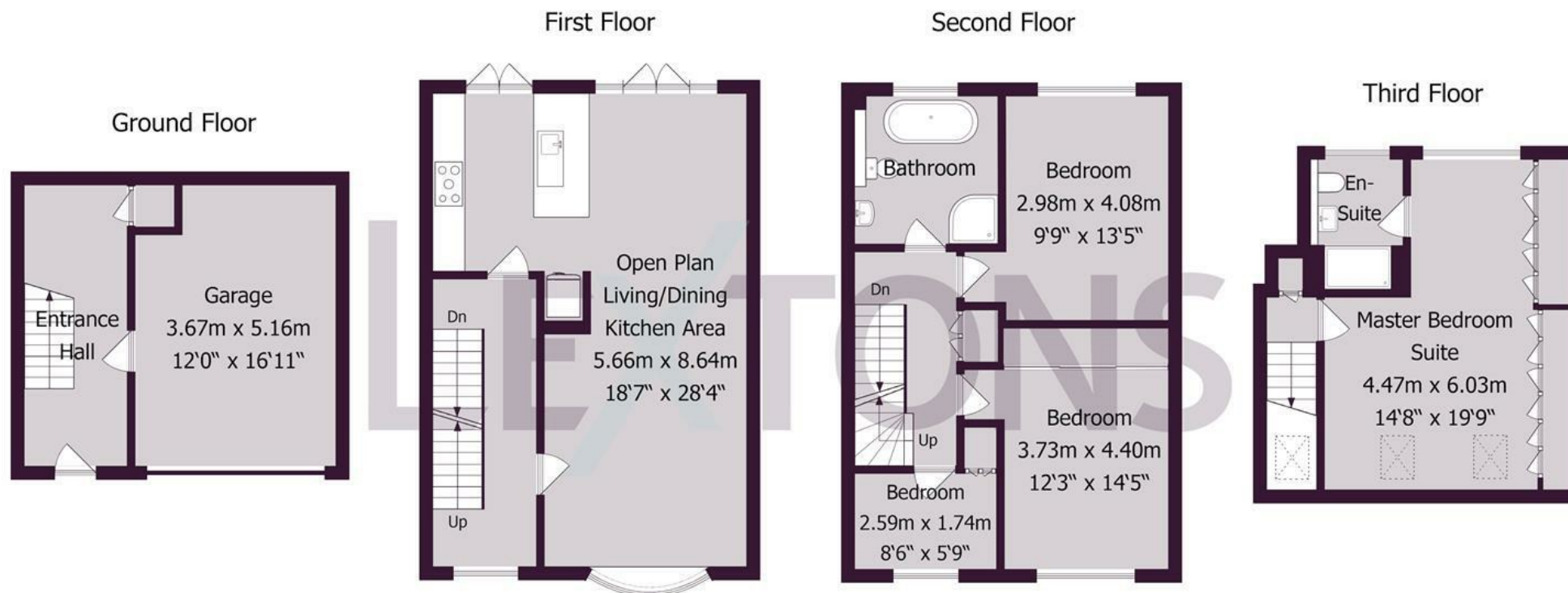

Approximate gross internal floor area 159.9 sq m/ 1721 sq ft

Whilst every care has been taken to ensure accuracy, dimensions are approximate and for illustrative purposes only.

Created by Property Photography UK for Lextons. All rights reserved.

Meet us here...
174 Church Road
Hove
BN3 2DJ

We aim to make our particulars both accurate and reliable. However they are not guaranteed; nor do they form part of an offer or contract. If you require clarification on any points then please contact us, especially if you're traveling some distance to view. Please note that appliances and heating systems have not been tested and therefore no warranties can be given as to their good working order.



LEXTONS.co.uk