

# Payne Avenue

## Hove

**LEX**TONS /  
SALES  
LETTINGS  
AUCTIONS  
COMMERCIAL



## About the property

Guide price £275,000 - £300,000

A bright and spacious one-bedroom garden apartment, enviably located on a popular residential street in the ever-desirable Poets Corner.

This modern and beautifully presented home has been decorated to a high standard throughout. The welcoming reception room features an attractive south-facing bay window, filling the space with natural light and offering plenty of room for a dining table.

To the rear of the property, the peaceful double bedroom overlooks the beautifully maintained garden, creating a serene retreat. The well-appointed kitchen also opens directly onto the generous private garden—an unusually large outdoor space for the area—featuring two patio areas, raised beds, and mature planting, perfect for entertaining or relaxing in a tranquil setting.

Conveniently positioned on a quiet road in the heart of Poets Corner, the apartment is within walking distance of the seafront and moments from the excellent selection of cafes, restaurants, bars, and shops on Portland Road, Blatchington Road, and Church Road.

Aldrington and Hove train stations are both nearby, providing excellent transport links.

## Payne Avenue Hove



1

BEDROOM

1

RECEPTION

1

BATHROOM

















SCAN HERE TO OFFER ON THIS PROPERTY

## Ground Floor

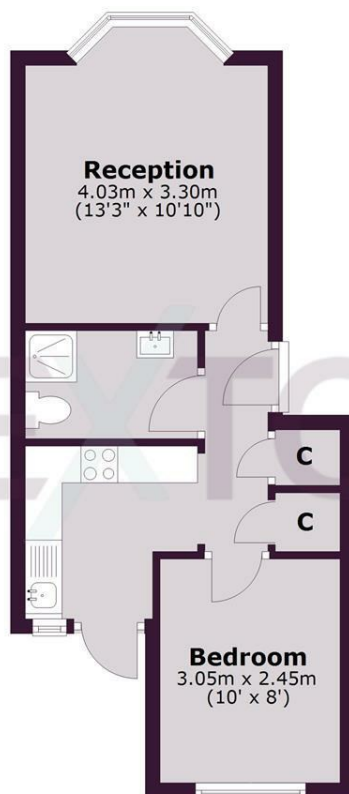

Whilst every care has been taken to ensure accuracy, dimensions are approximate and for illustrative purposes only.  
Created for exclusive use for Lextons. All rights reserved.  
Plan produced using PlanUp.

Energy Efficiency Rating		
	Current	Potential
Very energy efficient - lower running costs		
(92 plus) A		
(81-91) B		
(69-80) C	70	76
(55-68) D		
(39-54) E		
(21-38) F		
(1-20) G		
Not energy efficient - higher running costs		
England & Wales		EU Directive 2002/91/EC

**LEXTONS**

Call our sales team to arrange  
a viewing appointment:

**01273 56 77 66**

174 Church Road, Hove, BN3 2DJ  
hovesales@lextons.co.uk | www.lextons.co.uk