

Brunswick Place

Hove

LEXTONS /
SALES
LETTINGS
AUCTIONS
COMMERCIAL



About the property

An attractive one-bedroom split-level apartment, set within an impressive Regency building just moments from the seafront in the ever-popular Brunswick neighbourhood of Hove.

Beautifully presented, the apartment opens into a welcoming hallway, with a few steps leading up to a spacious open-plan kitchen and reception room. Light and airy, the space combines stripped wood floorboards, a large sash window, and high ceilings, creating a sociable setting with period charm and character.

The double bedroom is peacefully positioned to the rear of the property and enjoys excellent natural light from two sash windows, with stripped wood floors continuing throughout. Adjacent, a good-sized shower room is presented in a smart, modern décor.

This homely apartment is ideally located on one of Hove's most desirable avenues, just off Western Road with its vibrant mix of cafés, bakeries, restaurants, and everyday amenities. The seafront is only a short stroll away, while Hove station is within easy reach, offering excellent connections for commuters.

Brunswick Place Hove



1

BEDROOM

1

RECEPTION

1

BATHROOM









SCAN HERE TO OFFER ON THIS PROPERTY

Second Floor

Approx. 33.6 sq. metres (362.0 sq. feet)

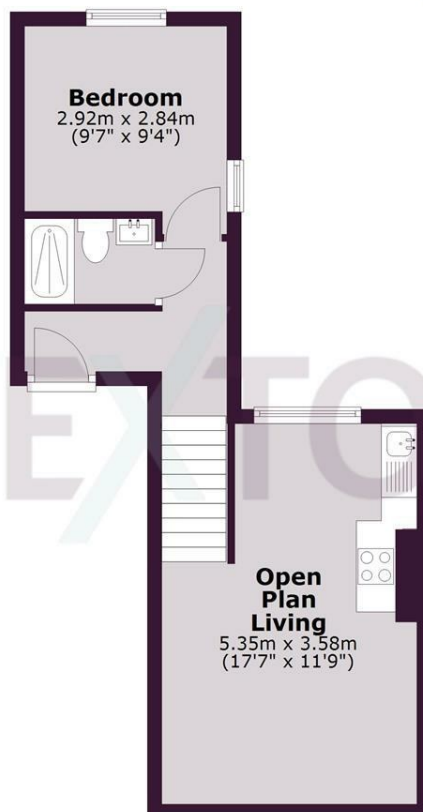

Total area: approx. 33.6 sq. metres (362.0 sq. feet)

Whilst every care has been taken to ensure accuracy, dimensions are approximate and for illustrative purposes only.
Created for exclusive use for Lextons. All rights reserved.
Plan produced using PlanUp.

Energy Efficiency Rating		
	Current	Potential
Very energy efficient - lower running costs		
(92 plus) A		
(81-91) B		
(69-80) C		
(55-68) D		
(39-54) E		
(21-38) F		
(1-20) G		
Not energy efficient - higher running costs		
England & Wales		EU Directive 2002/91/EC