

## St. Catherines Terrace, Hove

£260,000

This large one-bedroom apartment is set within a large period building, situated moments away from the seafront; the property benefits from stunning views of Hove Beach and has excellent access to an amazing selection of amenities on Church Road.

As you enter from the communal parts, the hallway provides access to all rooms as well as a guest cloakroom. The reception is an excellent size, over eighteen feet in length, boasting large South facing sash windows with sea views. There is an opening between the kitchen and living room, which gives an open plan feel but still offers some separation. The kitchen is modern in style and has plenty of fitted units. The bedroom is a considerable size, again benefiting from large sash windows, luxurious sea views, fitted storage space and an en-suite bathroom.

St Catherines Terrace is part of Kingsway, which is a road running alongside the seafront. The famous Marrocco's Ice Cream store is a short distance away, as is Church Road which offers plenty of amenities including bars, restaurants and Tesco Superstore.



1



1



1



C

St. Catherines Terrace, BN3

£260,000

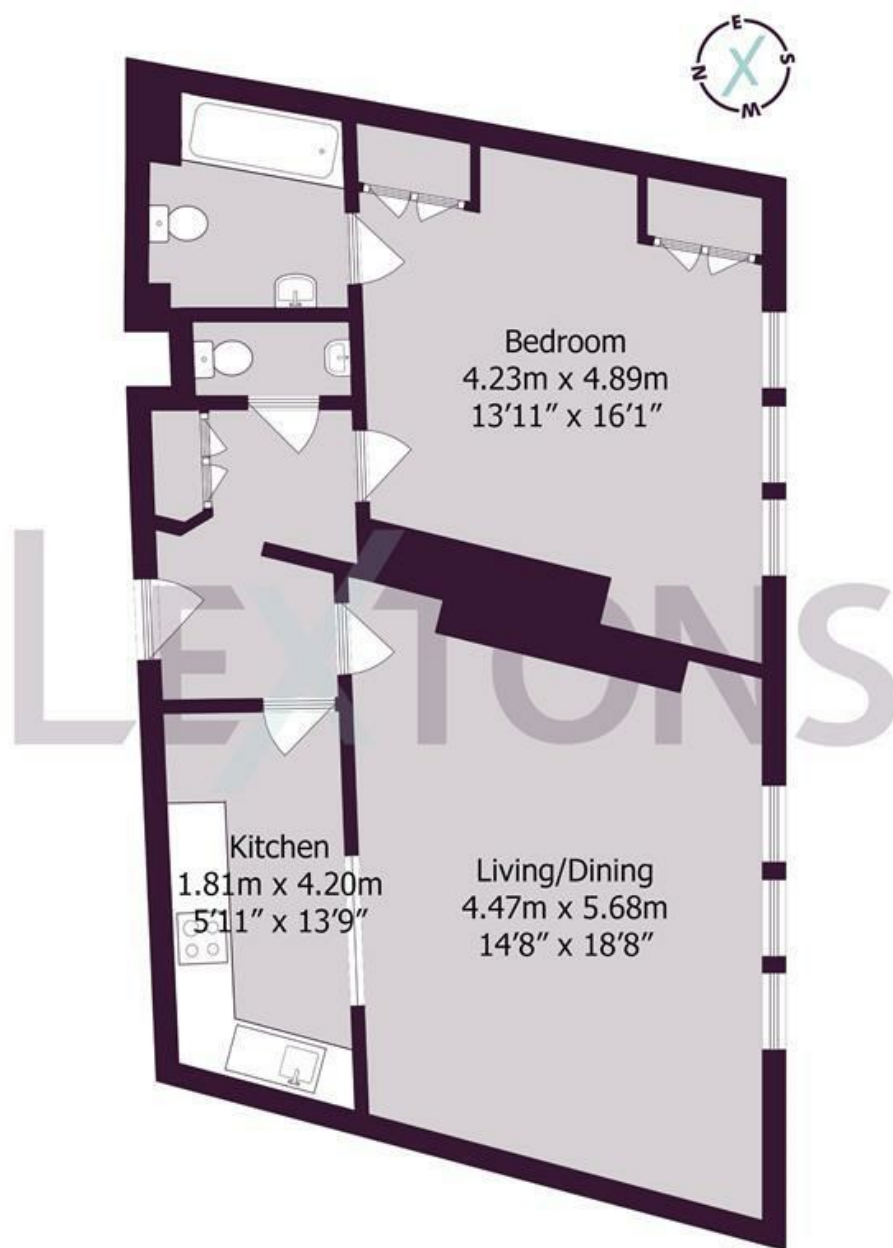

Approximate gross internal floor area 66 sq m/ 710 sq ft

Whilst every care has been taken to ensure accuracy, dimensions are approximate and for illustrative purposes only.

Created by Property Photography UK for Lextons. All rights reserved.

Meet us here...

174 Church Road  
Hove  
BN3 2DJ

We aim to make our particulars both accurate and reliable. However they are not guaranteed; nor do they form part of an offer or contract. If you require clarification on any points then please contact us, especially if you're traveling some distance to view. Please note that appliances and heating systems have not been tested and therefore no warranties can be given as to their good working order.