

Brunswick Place, Hove

£300,000

This lovely ground floor, one-bedroom apartment with a courtyard is perfectly situated in central Hove. The property boasts high ceilings, modern décor and large windows that illuminate the space. Brunswick Place is neatly positioned between Western Road and Lansdowne Road, tucked away from the hustle and bustle of the city centre but within walking distance of the many amenities, Hove has available.

On entering the apartment, a spacious hallway, with room to be utilised in part as a study area or home, provides access to all rooms. Directly to the left is the large open plan reception; the room offers a modern kitchen space with integrated appliances, an area for dining and entertaining as well as a door that leads to the courtyard. To the rear of the apartment is the bedroom, which is a good size and also has access to the outside space. There is also a family bathroom with both shower and bath facilities.

Brunswick Place is located between Lansdowne Road and Western Road, where you will find most of Brighton and Hove's most popular bars, restaurants and shops. Western Road leads to Churchill Square shopping centre, which is certainly a walkable distance from this apartment, as is the seafront itself.



1



1



1



Exempt

Brunswick Place, BN3

£300,000

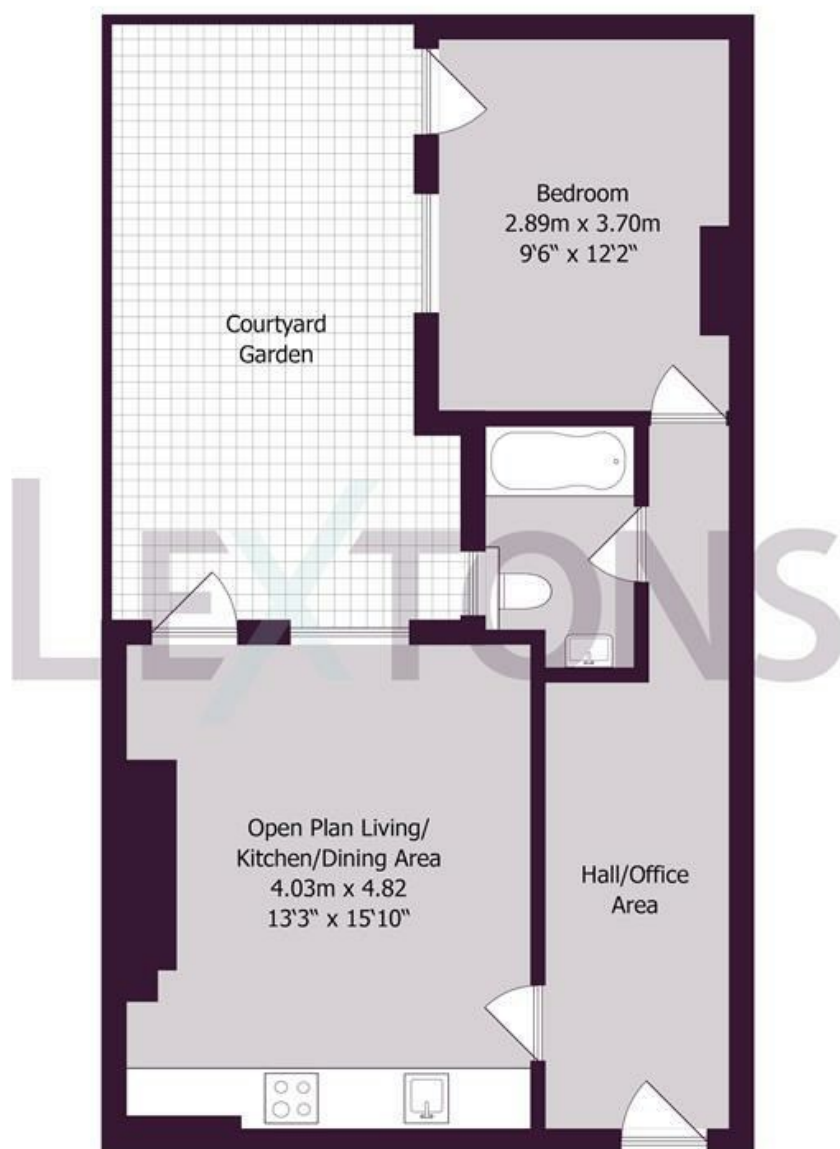

Approximate gross internal floor area 45.3 sq m/ 488 sq ft

Whilst every care has been taken to ensure accuracy, dimensions are approximate and for illustrative purposes only.

Created by Property Photography UK for Lextons. All rights reserved.

Meet us here...

174 Church Road
Hove
BN3 2DJ

We aim to make our particulars both accurate and reliable. However they are not guaranteed; nor do they form part of an offer or contract. If you require clarification on any points then please contact us, especially if you're traveling some distance to view. Please note that appliances and heating systems have not been tested and therefore no warranties can be given as to their good working order.