



Altissima House,
London, SW11 8BY
£1,357,000 Leasehold

GARTON JONES.COM

Vista Chelsea Bridge,
Altissima House,
London, SW11 8BY

£1,357,000 Leasehold



Located on the first floor this luxurious two bedroom apartment is comprised of an open plan fully fitted kitchen and spacious and bright living room, two large bedrooms, and two bathrooms. There is a sun catching terrace with views over the communal gardens and Battersea Park accessible from all the rooms, and plenty of storage cabinets.

Beautiful, sculptural building called Vista, Chelsea Bridge Wharf. Located between the wide open spaces of Battersea Park and the exciting redevelopment of Battersea Power Station. The breathtaking design of the building is matched by the luxury finishes internally and fabulous views.

- Two double bedrooms
- Two large bathrooms
- Dual Aspect - Communal Garden & Battersea Park
- Spacious Balcony
- Open plan reception
- 845 sq ft | 78.5 sq m
- First floor
- 24 Hour Concierge
- Gym and swimming pool
- Excellent travel links

Altissima Building

Approximate Gross Internal Area = 845 sq ft / 78.5 sq m

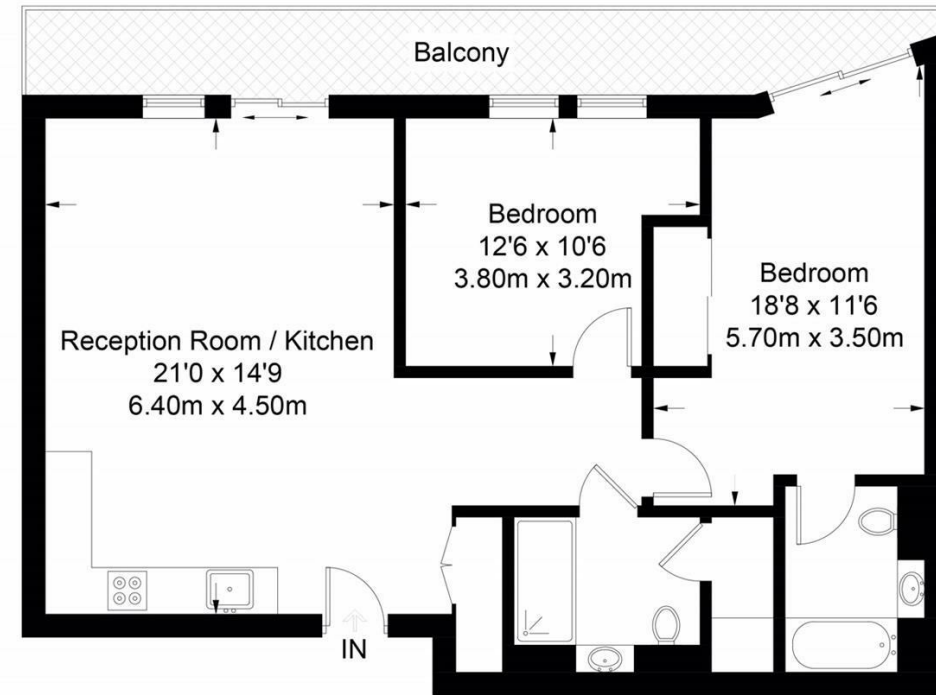

First Floor

Not to scale, for guidance only and must not be relied upon as a statement of fact. All measurements and areas are approximate only and have been prepared in accordance with the current edition of the RICS Code of Measuring Practice.