



Chelsea Bridge Wharf,  
London, SW11 8NT  
£600 Per Week

GARTON JONES.COM





Eustace Building,  
Chelsea Bridge Wharf,  
London, SW11 8NT

£600 Per Week



Luxury two bedroom apartment located on the sixth floor in the Eustace Building at Chelsea Bridge Wharf. Open plan kitchen and lounge area. Spacious terrace with views of the peaceful piazza water gardens. Master bedroom with en-suite bathroom. Second bedroom and separate shower room. 'Comfort cooling' and storage space throughout the apartment.

Chelsea Bridge Wharf is London's most glamorous riverside development located just 0.75 miles from Sloane Square and adjacent to the wide open spaces of Battersea Park and the River Thames. 24 hour concierge service and security service.

- Luxury Two Bedroom, Two Bathroom
- Garden Facing Aspect
- Balcony
- Spacious Open Plan Reception
- 769 sq ft
- Sixth Floor
- 24 Hour Concierge

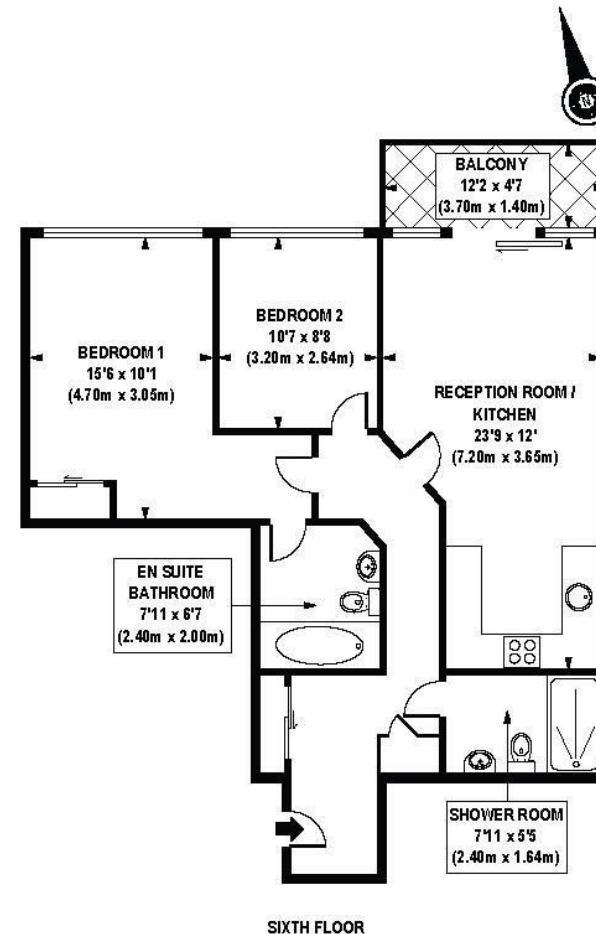

SIXTH FLOOR

APPROX. GROSS INTERNAL FLOOR AREA 769 sq. ft / 71.41 sq. m