



Chelsea Bridge Wharf,
London, SW11 8AE
£385 Per Week

GARTON JONES.COM



Hawker Building,
Chelsea Bridge Wharf,
London, SW11 8AE

£385 Per Week



Stylish one bedroom apartment located on the third floor of the Hawker Building, Chelsea Bridge Wharf. Large living/dining area with a fully equipped open plan kitchen. Large balcony with views overlooking the piazza. Spacious double bedroom with a separate tiled bathroom. Floor to ceiling windows throughout allow in plenty of light.

Chelsea Bridge Wharf is London's most glamorous riverside development located just 0.75 miles from Sloane Square and adjacent to the wide open spaces of Battersea Park and the River Thames. 24 hour concierge service and security service.

- One bedroom, One bathroom
- Views overlooking Piazza
- Balcony
- Open plan Kitchen
- 494 sq ft
- Third floor
- 24 hour Concierge

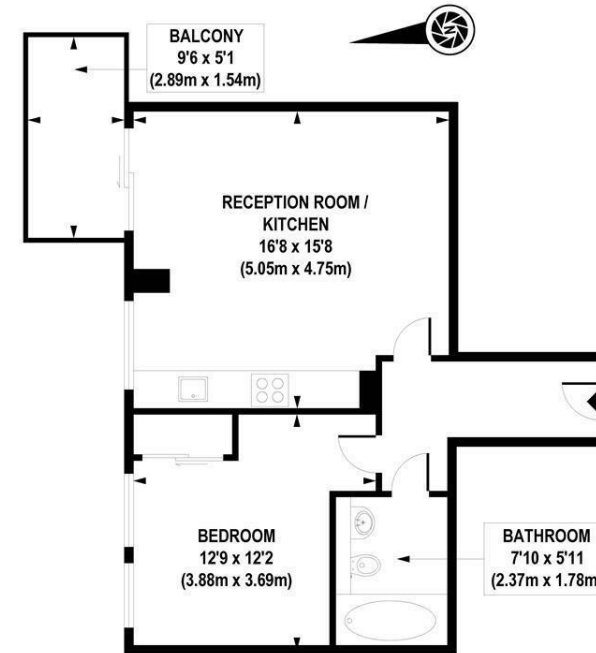

THIRD FLOOR

APPROX. GROSS INTERNAL FLOOR AREA 494 sq. ft / 45.94 sq. m