



Chelsea Bridge Wharf,
London, SW11 8NT
£365 Per Week

GARTON JONES.COM

Eustace building,
Chelsea Bridge Wharf,
London, SW11 8NT

£365 Per Week



A vibrant one bedroom apartment located on the first floor in the Eustace Building at Chelsea Bridge Wharf. This lovely apartment is east facing with fantastic views of the beautiful piazza water gardens. Open plan kitchen and lounge area with access to the large terrace. Full length windows. Great size bedroom and separate bright bathroom. Good storage.

Chelsea Bridge Wharf is London's most glamorous riverside development located just 0.75 miles from Sloane Square and adjacent to the wide open spaces of Battersea Park and the River Thames. 24 hour concierge service and security service. It is also immediately next to the exciting Battersea Power Station project and the forthcoming Northern Line Underground extension.

- Luxury One Bedroom, One Bathroom
- Water Garden Views
- Balcony
- Open plan Reception and Kitchen area
- 502 sq ft
- First floor
- Modern Finish Throughout
- 24 hour Concierge
- Excellent travel Links

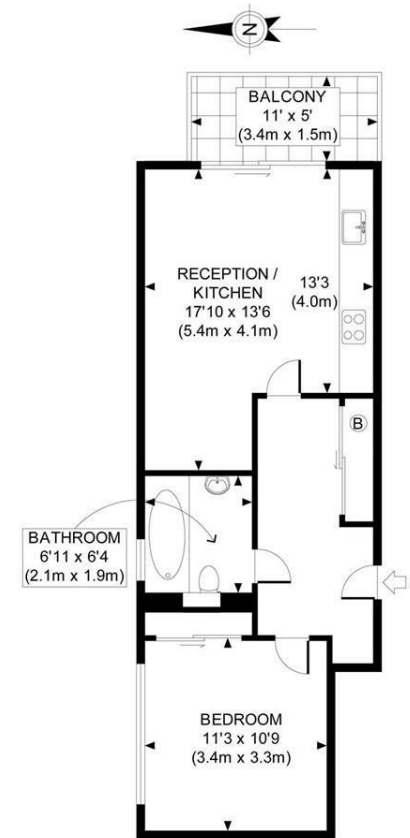

FIRST FLOOR
GROSS INTERNAL
FLOOR AREA 502 SQ FT

APPROX. GROSS INTERNAL FLOOR AREA 502 SQ FT / 47 SQ M
Ref: MRGJCBW - 031110
Floorplans are for identification and guideline purposes only, not to scale.