



Severnside, Bridgnorth, WV16 6NU

**SHELDON
BOSLEY
KNIGHT** LAND AND
PROPERTY
PROFESSIONALS

Property Description

Available by Traditional Auction- Approximately One acre with four bedroom freehold residential chalet and planning permission to rebuild fire damaged property adjacent.

The planning permission was granted by Shropshire Council 11th July 2025 under planning reference 25/01812/FUL. Searching for this reference on their planning portal you will find a topographical survey, proposed plans, location plan and design & access statement.

This Lot comprises of two Freehold Titles: SL218313 and SL35112.

24-25 The Bungalows is set within an elevated position with views over the River Severn, close to the Severn Valley Railway Station, making an ideal country retreat or holiday home.

Set within approx. one acre, the lot includes a four bedroom detached chalet, planning permission to re-build the adjacent property, a caravan and extensive gardens with gated access.

LOCATION: Highley occupies a commanding position on a ridge dividing the picturesque but contrasting valleys of the Severn Valley and Borle Brook. Dating back to the 7th Century, Highley is one of the largest villages in Shropshire. Formerly a traditional mining area, Highley has transformed into a popular commuter village with a range of shops and local amenities including the Severn centre and Highley primary school.

Auction Details:

Nock Deighton Land and Property Auction
Wednesday 25th March 2026, 5.00pm (doors open at 4.00pm)
Bridgnorth Rugby Club, Edgar Davies Ground,
Bandon Lane, Bridgnorth WV15 5AD





Key Features

- For sale by Public Auction 25th March 5pm at Bridgnorth Rugby Club
- One Acre Plot
- Planning Permission To Rebuild Adjacent Chalet
- Gated Access
- Riverside Views
- Four Bedroom Chalet
- Caravan
- Gardens

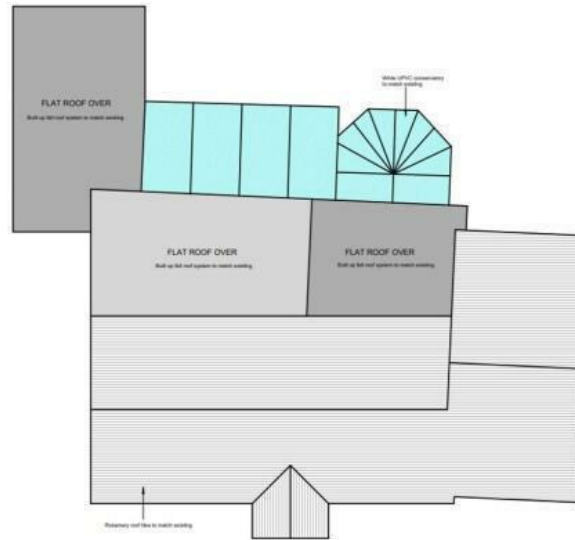

Auction Guide
£150,000

EPC Rating -

Tenure - Freehold

Council Tax Band - A

Local Authority -
Shropshire

DISCLAIMER

All fixtures and fittings mentioned in these particulars are included in the sale, all others in the property are specifically excluded. Photographs are reproduced for general information and it must not be inferred that any item is included for sale with the property. These particulars are thought to be materially correct. Their accuracy is not guaranteed and they do not form part of any contract.

We routinely refer clients to both our recommended Legal Firm and a panel of Financial Services Providers. It is your decision whether you choose to deal with these companies. In making that decision, you should know that we receive a referral fee