

Little Oakley
Corby
NN18 8HA

£400,000



OSCAR JAMES

...expect excellence

FLOOR PLANS

GROUND FLOOR
470 sq.ft. (43.6 sq.m.) approx.

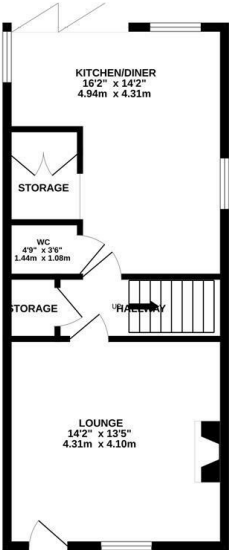

1ST FLOOR
376 sq.ft. (34.9 sq.m.) approx.

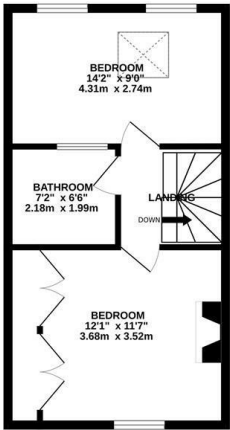

2ND FLOOR
189 sq.ft. (17.5 sq.m.) approx.

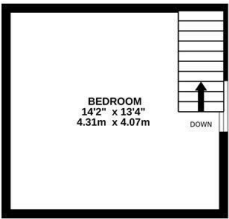

TOTAL FLOOR AREA : 1034 sq.ft. (96.1 sq.m.) approx.
Whilst every attempt has been made to ensure the accuracy of the floorplan contained here, measurements of doors, windows, rooms and any other items are approximate and no responsibility is taken for any error, omission or mis-statement. This plan is for illustrative purposes only and should be used as such by any prospective purchaser. The services, systems and appliances shown have not been tested and no guarantee as to their operability or efficiency can be given.
Made with Metropix ©2025



AT A GLANCE...



custom text 1



custom text 4



custom text 2



custom text 5



custom text 3



custom text 6



WHAT'S GREAT?

"OLDEST HOUSE IN THE VILLAGE"

Oscar James are delighted to offer this picture-perfect period cottage, brimming with character yet updated for modern living.

Set in a peaceful spot with a lovely rear and front gardens, this home is ideal for those seeking something truly special.

Step inside and you'll find:

A warm and inviting lounge complete with a charming log burner – perfect for cosy evenings

A stunning extended kitchen Diner with fitted appliances, blending style and practicality

A downstairs WC and additional; cloakroom for added convenience

Three double bedrooms allowing for a growing family.

A gorgeous four piece, family bathroom featuring a roll-top bath and separate shower.

This wonderfully historic example oozes character and is in one of the most desirable locations in the county.

Little Oakley is a small village located in the county of Northamptonshire, England. The village is situated in the north-eastern part of the county, close to the border with the neighbouring county of Leicestershire. Little Oakley is a rural village with a population of around 200 people. The village is surrounded by beautiful countryside, with rolling hills and fields of crops stretching as far as the eye can see.

The village of Little Oakley has a rich history, with evidence of human habitation dating back to the Bronze Age. The village was mentioned in the Domesday Book of 1086, where it was recorded as "Achelai". The village has a number of historic buildings, including the 12th-century St. Peter's Church, which is a Grade II listed building. The church is a beautiful example of Norman architecture, with a striking tower and a number of interesting features, including a medieval font and a 14th-century tomb.

...expect excellence



SELLER'S SECRET

This has been our family home for many years now and we will be very sad to leave, our increasing family has made us to want to upsize.



Why we like it....

A really beautiful period property set in open countryside but within striking distance of all amenities.

OSCAR JAMES

13 New Post Office Square | Corby | NN17

1PB

01536 400900

www.oscar-james.com

To buy or not to buy....
