

Morley Street
Kettering
NN16 9LJ

£230,000



OSCAR JAMES

...expect excellence

FLOOR PLANS

GROUND FLOOR
612 sq.ft. (56.9 sq.m.) approx.

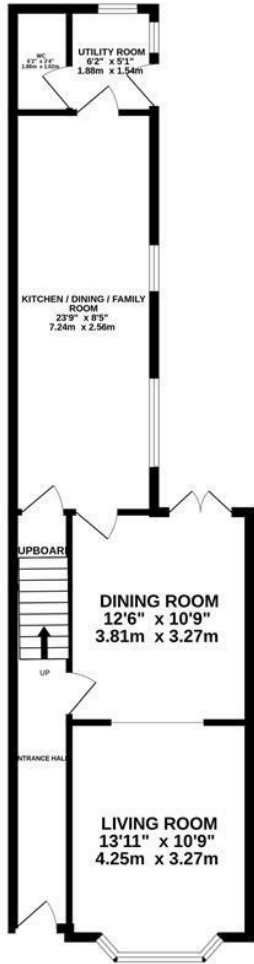

1ST FLOOR
538 sq.ft. (50.0 sq.m.) approx.

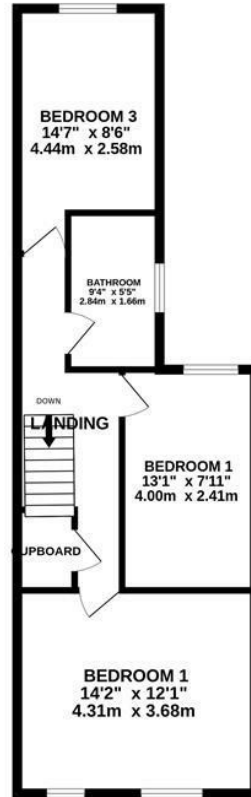

TOTAL FLOOR AREA : 1150 sq.ft. (106.9 sq.m.) approx.

Whilst every attempt has been made to ensure the accuracy of the floorplan contained here, measurements of doors, windows, rooms and any other items are approximate and no responsibility is taken for any error, omission or mis-statement. This plan is for illustrative purposes only and should be used as such by any prospective purchaser. The services, systems and appliances shown have not been tested and no guarantee as to their operability or efficiency can be given.

Made with Metroplan ©2026



AT A GLANCE...



Lounge



kitchen/Diner



Three Bedrooms



WC/Family Bathroom



Private Rear Garden



On Street Parking



WHAT'S GREAT?

Located on the north end of Kettering, is this lovely three bedroom Victorian bay fronted terrace property, within walking distance to the popular Pleasure Park.

As you enter this bay-fronted home, you are welcomed into a lovely hall way, which leads onto the spacious open-plan lounge and dining area, the ground floor also features a beautifully refitted kitchen diner, complete with contemporary fittings, a utility room for added practicality, and a convenient downstairs toilet.

Venturing upstairs, you will find three well-proportioned bedrooms, the family bathroom is thoughtfully designed and has been refitted.

Outside you have a private enclosed low maintenance rear garden, with patio area to enjoy the sun.

Please call Oscar James to arrange a viewing.

...expect excellence



SELLER'S SECRET

We have loved living in this property, we are looking for something slightly bigger.



Why we like it....

A great family home situated on the north end of Kettering.

OSCAR JAMES

1 Newland Street | Kettering | NN16 8JH

01536 415777

www.oscar-james.com

To buy or not to buy....
