

34 Lahnstein Court  
Kettering  
NN16 0DR

£120,000 offers in excess of



OSCAR JAMES

...expect excellence

# FLOOR PLANS

GROUND FLOOR  
748 sq.ft. (69.5 sq.m.) approx.

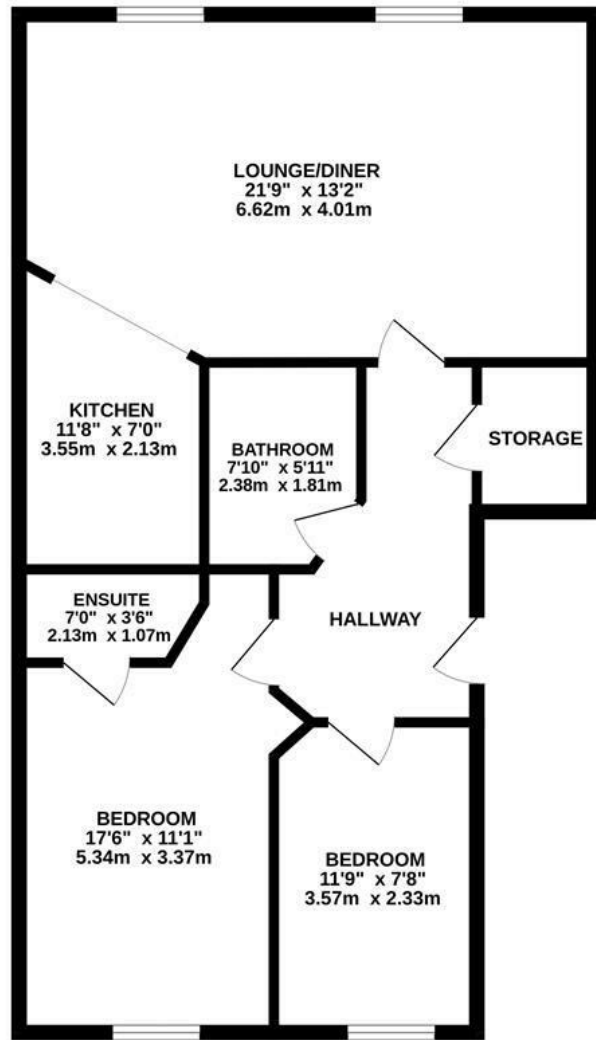

## AT A GLANCE...



Open plan kitchen/diner/lounge



Modern kitchen



Two bedrooms



Family bathroom and ensuite



Allocated parking space



TOTAL FLOOR AREA : 748 sq.ft. (69.5 sq.m.) approx.

Whilst every attempt has been made to ensure the accuracy of the floorplan contained here, measurements of doors, windows, rooms and any other items are approximate and no responsibility is taken for any error, omission or mis-statement. This plan is for illustrative purposes only and should be used as such by any prospective purchaser. The services, systems and appliances shown have not been tested and no guarantee as to their operability or efficiency can be given.

Made with Metropix 6/2025



## WHAT'S GREAT?

Offered to market with NO CHAIN and in prime position within the Kettering town centre with ALLOCATED parking for one vehicle this apartment is a superb size and must be viewed to be appreciated.

kitchen/diner/lounge this property would make an ideal first time buy or rental investment.

The property is situated on the first floor and has one allocated parking space in the car park out front.

With two very good size bedrooms, the master of which benefits from an ensuite shower room, a family bathroom, storage cupboard and huge open plan

Call sole selling agents Oscar James Kettering to make arrangements to view.

...expect excellence



# SELLER'S SECRET

Having owned for a number of years as a very successful rental investment the time is right for me, now that it is vacant to sell. Sure it will make a great home for someone new.



*Why we like it....*

A very large apartment in an ideal town centre location with parking, a must view!

## OSCAR JAMES

1 Newland Street | Kettering | NN16 8JH  
01536 415777  
[www.oscar-james.com](http://www.oscar-james.com)

To buy or not to buy....

---

---

---

---

---