



67 Finedon Street,
Burton Latimer, NN15 5SB

OSCAR JAMES

£200,000

ESTATE AGENTS

The Property in Brief...

This CHAIN FREE well loved four bedroomed Victorian property is situated in Burton Latimer, walking distance to all the local amenities and offers a fantastic amount of space and potential.

Burton Latimer is a small market town with so much to offer, it has an abundance of eateries, shops, schools and is surrounded by beautiful countryside. Not only this but neighbouring towns offer fantastic train links that can get you into London within the hour.

This character property is set over two floors and really is like a Tardis, upon entering you'll be greeted with a large entrance hall leading to the spacious lounge, with beautiful bay window and feature fireplace, separate dining room with French doors out to the garden and the great sized kitchen with large storage cupboard and more access to the garden.

Upstairs there are four bedrooms, two large doubles and two singles, and the family bathroom which has been converted into a wet room.

Outside the property has a lovely frontage and to the rear is a fully enclosed established garden, with private side access, and a couple of brick built storage sheds, and even a half converted outbuilding at the rear of the garden.

This is a home that buyers can put their own stamp on as it has bags of potential, to arrange to come and view it, please give Oscar James a call today.



Dimensions

What our vendors say...

This was our family home and we loved growing up here, there's so many happy memories here, we really hope that the new buyers will enjoy the home as much as we all have.

GROUND FLOOR
643 sq.ft. (59.7 sq.m.) approx.

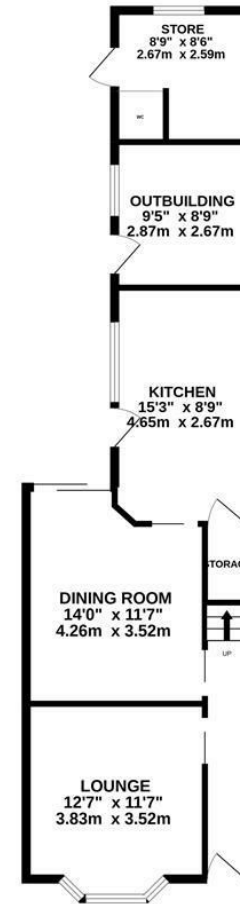

1ST FLOOR
554 sq.ft. (51.5 sq.m.) approx.

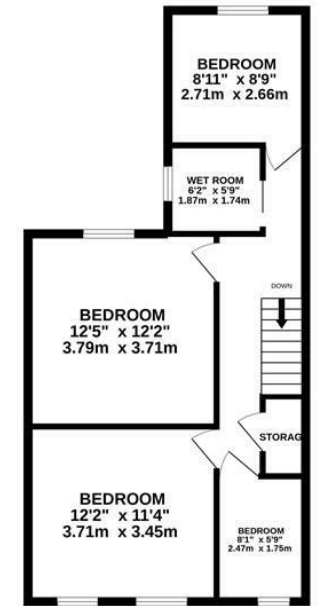

TOTAL FLOOR AREA: 1197 sq.ft. (111.2 sq.m.) approx.

Whilst every attempt has been made to ensure the accuracy of the floorplan contained here, measurements of doors, windows, rooms and any other items are approximate and no responsibility is taken for any error, omission or mis-statement. This plan is for illustrative purposes only and should be used as such by any prospective purchaser. The services, systems and appliances shown have not been tested and no guarantee as to their operability or efficiency can be given.
Made with Metropix ©2022



Find us at;
45 High Street
Burton Latimer, NN15 5LB

01536 722 222
burton@oscar-james.com
www.oscar-james.com
Follow us on Facebook

Whilst every attempt has been made to ensure the accuracy of the floor plan and details contained here, measurements of doors, windows, rooms and any other items are approximate and no responsibility is taken for any error, omission, or mis-statement. This plan is for illustrative purposes only and should be used as such by any prospective purchaser. The services, systems and appliances shown have not been tested and have no guarantee as to their operability or efficiency can be given. Floor plan made with Metropix 2014. Fixtures and fittings may vary at point of sale.

