



34 Spinney Road,  
Burton Latimer, NN15 5ND

OSCAR JAMES

£210,000

ESTATE AGENTS

# The Property in Brief...

*Offered to the market with no onward chain, this well-presented two-bedroom semi-detached home occupies a pleasant cul-de-sac position in the popular town of Burton Latimer and benefits from off-road parking for multiple vehicles.*

*The accommodation begins with a welcoming entrance hall providing access to the principal ground-floor rooms. The kitchen offers ample storage and workspace, with plenty of room for freestanding appliances. To the rear of the property, the spacious lounge/dining room provides an excellent space for both relaxing and entertaining, with patio doors opening directly onto the rear garden and allowing an abundance of natural light to flow through the room.*

*The first floor comprises two well-proportioned bedrooms, both offering comfortable living accommodation, along with a family bathroom fitted with a modern suite and shower over the bath.*

*Externally, the rear garden has been designed for low-maintenance enjoyment and features a generous slabbed patio area, ideal for outdoor dining and entertaining. The remainder of the garden is predominantly laid to lawn, providing an excellent space for families, pets, or keen gardeners.*

*With its chain-free status, cul-de-sac location, generous parking provision and well-balanced accommodation, this property represents an excellent opportunity for first-time buyers, downsizers, or investors alike.*



# Dimensions

## Kitchen

5'11" x 10'1" (1.80 x 3.07)

## Living Room

11'0" x 13'0" (11'00" x 13'00") (3.35 x 3.96)

## Master Bedroom

11'0" x 9'8" (11'00" x 9'08" ) (3.35 x 2.95)

## Bedroom Two

11'0" x 6'10" (3.35 x 2.08)

## Bathroom

6'0" x 6'0" (1.83 x 1.83)

What our vendors say...

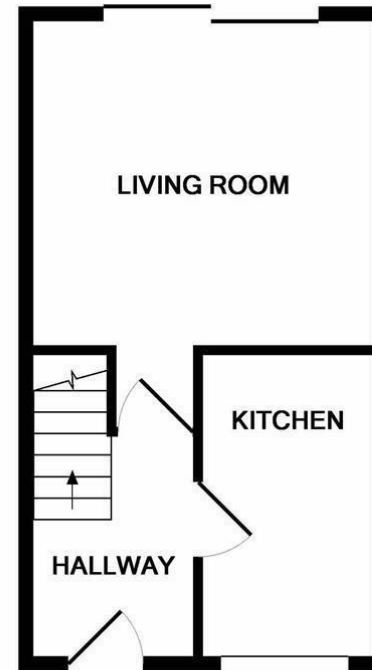

GROUND FLOOR  
APPROX. FLOOR  
AREA 250 SQ.FT.  
(23.2 SQ.M.)

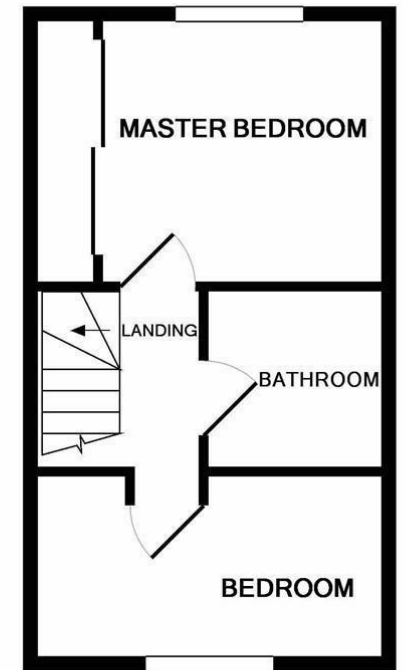

1ST FLOOR  
APPROX. FLOOR  
AREA 253 SQ.FT.  
(23.5 SQ.M.)

TOTAL APPROX. FLOOR AREA 503 SQ.FT. (46.8 SQ.M.)

Whilst every attempt has been made to ensure the accuracy of the floor plan contained here, measurements of doors, windows, rooms and any other items are approximate and no responsibility is taken for any error, omission, or mis-statement. This plan is for illustrative purposes only and should be used as such by any prospective purchaser. The services, systems and appliances shown have not been tested and no guarantee as to their operability or efficiency can be given

Made with Metropix ©2017

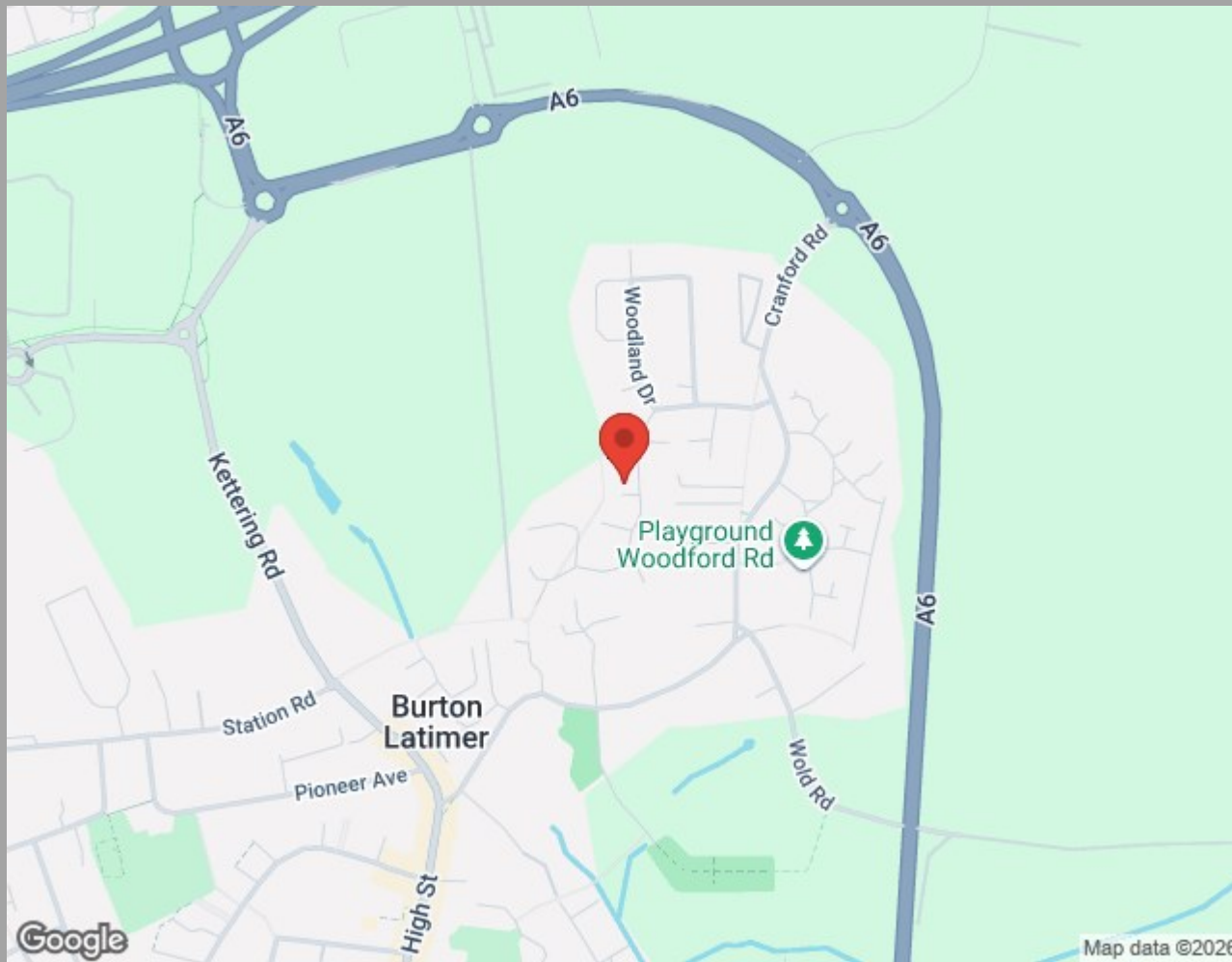

Find us at;  
45 High Street  
Burton Latimer, NN15 5LB

01536 722 222  
burton@oscar-james.com  
www.oscar-james.com  
Follow us on Facebook

Whilst every attempt has been made to ensure the accuracy of the floor plan and details contained here, measurements of doors, windows, rooms and any other items are approximate and no responsibility is taken for any error, omission, or mis-statement. This plan is for illustrative purposes only and should be used as such by any prospective purchaser. The services, systems and appliances shown have not been tested and have no guarantee as to their operability or efficiency can be given. Floor plan made with Metropix 2014. Fixtures and fittings may vary at point of sale.