

2 Emerson Court
Barton Seagrave
NN15 6YD

55% SHARED OWNERSHIP
£132,000



OSCAR JAMES

...expect excellence

FLOOR PLANS

GROUND FLOOR
358 sq.ft. (33.2 sq.m.) approx.

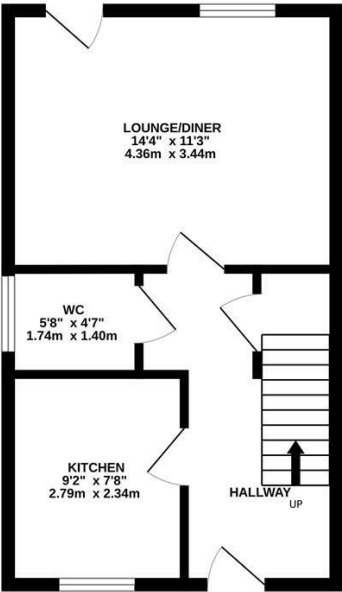

1ST FLOOR
358 sq.ft. (33.2 sq.m.) approx.

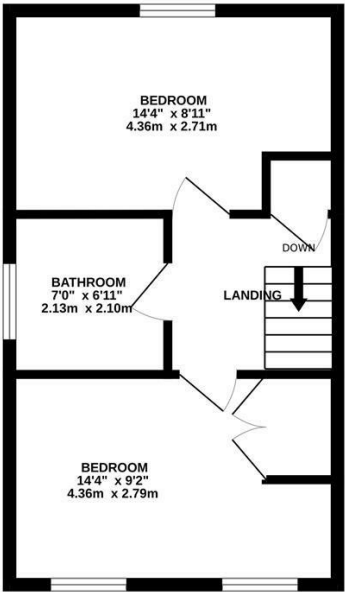

TOTAL FLOOR AREA : 716 sq.ft. (66.5 sq.m.) approx.
Whilst every attempt has been made to ensure the accuracy of the floorplan contained here, measurements of doors, windows, rooms and any other items are approximate and no responsibility is taken for any error, omission or mis-statement. This plan is for illustrative purposes only and should be used as such by any prospective purchaser. The services, systems and appliances shown have not been tested and no guarantee as to their operability or efficiency can be given.
Made with Metropix ©2026



AT A GLANCE...



Bright and airy lounge/diner



Two spacious double bedrooms



Ground floor WC and upstairs family bathroom



Low maintenance rear garden



Driveway providing off road parking for two vehicles



WHAT'S GREAT?

**** SHARED OWNERSHIP - 55% SHARE ****

Situated in the popular Hanwood Park of Barton Seagrave in a cul-de-sac location is this two bedroom SHARED OWNERSHIP home.

The property offers an inviting and practical living space. With the added convenience of off-road parking, this home is perfect for first-time buyers, small families, or anyone seeking a comfortable and accessible place to call their own.

The open-plan lounge diner serves as the central hub of this lovely home, providing a versatile and welcoming space for both relaxation and entertainment. A convenient downstairs W/C adds a touch of practicality to daily living. The kitchen is a delightful space located to the front of the property and enjoys plenty of natural light and boasts integrated appliances.

Upstairs you will find two spacious double bedrooms, each offering a peaceful retreat at the end of the day and family bathroom, which is well-appointed and features modern fixtures.

This home presents a wonderful opportunity. Its welcoming living spaces, practical layout, and accessible location make it a fantastic choice for those seeking their first home or downsizing without compromising on comfort.

The rent, service charge, maintenance charge & building insurance on the remaining 45% share is a combine total of £334.55 per month making this an affordable place to call home.

Be quick, as shared ownership properties in Barton Seagrave are few and far between and always sell incredibly quickly!

Contact Oscar James, Burton Latimer to arrange your viewing today!

...expect excellence



SELLER'S SECRET

This has been a fantastic starter home for me and i have loved living on the development which is friendly and conveniently located for the A14 and local shops. It is now right for us to find somewhere slightly bigger for our growing family.



Why we like it....

A really rare chance to purchase a 55% shared ownership home in a sought after development! Be quick, properties like these don't hang around for long!

OSCAR JAMES

45 High Street | Burton Latimer | NN15 5LB
01536 722 222
www.oscar-james.com

To buy or not to buy....
