

34  
Donnington Road  
Burton Latimer  
NN15 5WL  
£65,000

25% SHARE £65,000



OSCAR JAMES

...expect excellence



# FLOOR PLANS

GROUND FLOOR  
435 sq.ft. (40.5 sq.m.) approx.

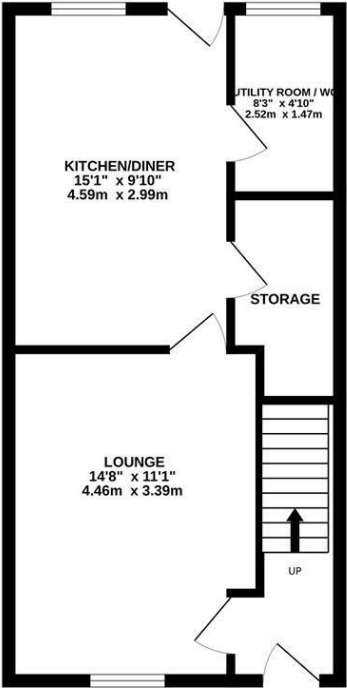

1ST FLOOR  
435 sq.ft. (40.5 sq.m.) approx.

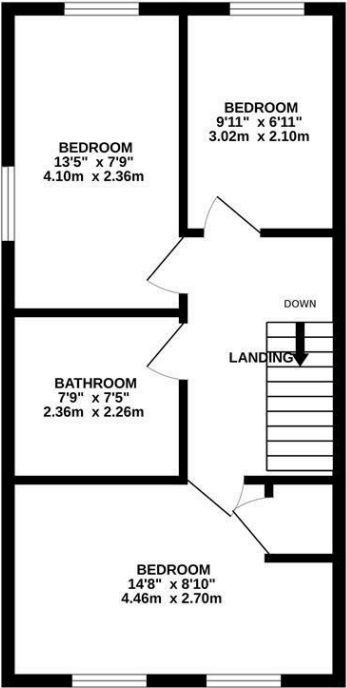

TOTAL FLOOR AREA : 871 sq.ft. (80.9 sq.m.) approx.  
Whilst every attempt has been made to ensure the accuracy of the floorplan contained here, measurements of doors, windows, rooms and any other items are approximate and no responsibility is taken for any error, omission or mis-statement. This plan is for illustrative purposes only and should be used as such by any prospective purchaser. The services, systems and appliances shown have not been tested and no guarantee as to their operability or efficiency can be given.  
Made with Metropix ©2025



## AT A GLANCE...



Large lounge



Kitchen/breakfast room & separate utility



Three bedrooms



Upstairs family bathroom and ground floor WC



Low maintenance rear garden



Off road parking for two vehicles



## WHAT'S GREAT?

**\*\*25% Shared Ownership \*\* Sold prior to marketing \*\***

This THREE bedroom end terrace property is offered to the market with NO ONWARD CHAIN and has the added benefit of off road parking for two vehicles.

Accommodation comprises; Entrance hallway providing access to the large lounge which over looks the front and the lounge leads into a good sized kitchen/breakfast room. The kitchen offers plenty of storage with space for white goods and access to the rear garden. A useful utility/WC and under stairs storage complete the downstairs.

To the first floor expect to find three good size bedrooms, two of which are DOUBLE in size and a family bathroom. The property is in good order throughout, however it does allow for a new buyer to put their own stamp on it.

Outside the rear garden is low maintenance and fully enclosed with access to the front and a useful storage shed.

25% Share

£355.02 Rent

£ 25.83 Service charge

110 years Remaining years on Lease Term

NB this property is a shared ownership home with East Midlands Housing Association (EMHA). Interested applicants will need to be qualified for EMHA eligibility.

Call sole selling agent OSCAR JAMES to register for other similar listings!

...expect excellence





# SELLER'S SECRET

This has been a great home for me. I love the space and three bedroom share ownerships homes are rare to come buy, so i was lucky to have the chance of homeownership in a space that was comfortable for my family.



## Why we like it....

A brilliant chance to get onto the property ladder in a family friendly sized home. Properties like this always attract a high level of interest, call as soon as possible to avoid missing out!

# OSCAR JAMES

45 High Street | Burton Latimer | NN15 5LB  
01536 722 222  
[www.oscar-james.com](http://www.oscar-james.com)

To buy or not to buy....

---

---

---

---

---