

51 Palmer Crescent
Burton Latimer
NN15 5GP

£157,500 (Fixed Price)



OSCAR JAMES

...expect excellence

FLOOR PLANS

GROUND FLOOR
352 sq.ft. (32.7 sq.m.) approx.

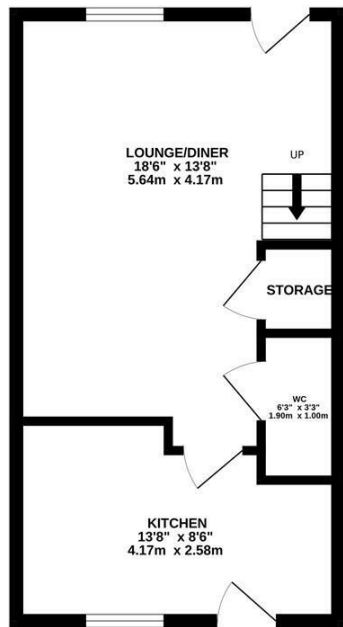

1ST FLOOR
352 sq.ft. (32.7 sq.m.) approx.

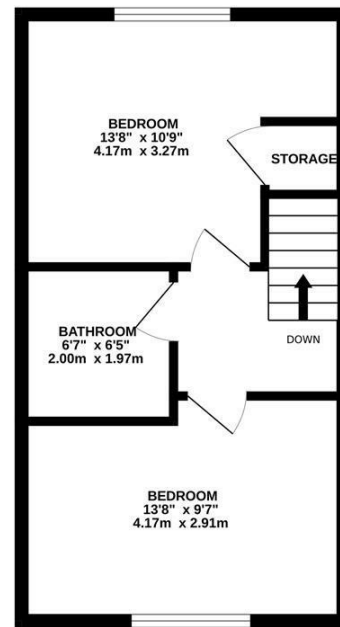

TOTAL FLOOR AREA : 704 sq.ft. (65.4 sq.m.) approx.

Whilst every attempt has been made to ensure the accuracy of the floorplan contained here, measurements of doors, windows, rooms and any other items are approximate and no responsibility is taken for any error, omission or mis-statement. This plan is for illustrative purposes only and should be used as such by any prospective purchaser. The services, systems and appliances shown have not been tested and no guarantee as to their operability or efficiency can be given.

Made with Metropix ©2024



AT A GLANCE...



Large Lounge Diner



Kitchen with Space for White Goods



2 Double Bedrooms



Family Bathroom & Downstairs W/C



Private Rear Garden with Decked Seating Area



Off Road Parking



WHAT'S GREAT?

**** SHARED OWNERSHIP - 70% SHARE ****

Nestled in the town of Burton Latimer, this charming two bedroom, end terrace property offers an inviting and practical living space. With the added convenience of off-road parking for TWO vehicles this home is perfect for first-time buyers, small families, or anyone seeking a comfortable and accessible place to call home.

The open-plan lounge diner serves as the central hub of this lovely home, providing a versatile and welcoming space for both relaxation and entertainment. A convenient downstairs W/C adds a touch of practicality to daily living. The kitchen is a great space located to the back of the property it boasts a range of base and eye level units, space for white goods and provides access to the rear garden.

To the first floor, you'll find two spacious double bedrooms and a family bathroom, well-appointed and featuring modern fixtures.

The rear garden is a good size and is mainly laid to lawn with a useful decked seating area. It is fully enclosed and has gated access to the front.

This home in Burton Latimer presents a wonderful opportunity. Its welcoming living spaces, practical layout, and brilliant location make it a fantastic choice for those seeking their first home or downsizing without compromising on comfort.

The rent on the remaining 30% is £180.18.

Contact Oscar James today to arrange your viewing today!

...expect excellence



SELLER'S SECRET

Perfect sized first property for a couple or small family, spacious living space and garden meant we always had things to do in a comfortable area. Quiet and friendly neighborhood with everything you could need within walking distance - shops, pub and lots of green space!



Why we like it....

Shared Ownership properties are a great way to get on the property ladder. Also, an option for anyone downsizing. The current owners have kept this immaculately and its the definition of a 'key turner'

To buy or not to buy....

OSCAR JAMES

45 High Street | Burton Latimer | NN15 5LB
01536 722 222
www.oscar-james.com
