



6 Lowick Close,
Burton Latimer, NN15 5UY

OSCAR JAMES

£245,000

ESTATE AGENTS

The Property in Brief...

**** SOLD PRIOR TO MARKETING ****

Located in a small cul-de-sac in Burton Latimer is this lovely three bedroomed semi-detached property, that has been beautifully maintained by the current owners and is offered to the market in immaculate condition.

This gorgeous home is situated just a short distance from its vibrant High Street filled with restaurants, cafés, hairdressers and more, yet also close to rolling countryside and open fields, perfect for walks and winding down with the family. Burton Latimer also offers excellent schooling, road and rail transport links with useful routes for commuters nearby.

The property is set over two floors and upon entering you will be greeted with, a lovely wide entrance hall useful cloakroom, well-equipped and stunningly presented kitchen/breakfast with integral appliances and spacious lounge/diner offering fabulous views of the garden through the French doors.

Upstairs there are two great sized double bedrooms, with the master bedroom benefitting from fitted wardrobes and an ensuite shower room, a third good size single and the immaculate family bathroom.

Outside there is a driveway, and to the rear is an attractive garden with a fabulous patio area and side access.

To arrange to view this spectacular home please call Oscar James today!



Dimensions

Lounge

15'4" x 10'5" (4.67 x 3.18)

WC

6'1" x 3'4" (1.85 x 1.02)

Kitchen

11'3" x 8'6" (3.43 x 2.59)

Bedroom 1

11'3" x 9'7" (3.43 x 2.92)

Ensuite

5'9" x 5'8" (1.75 x 1.73)

Bathroom

6'7" x 5'5" (2.01 x 1.65)

Bedroom 2

10'5" x 8'6" (3.18 x 2.59)

Bedroom 3

10'5" x 6'10" (3.18 x 2.08)

What our vendors say...

This house has been great for us as its in a lovely location close to all that Burton Latimer has to offer, our neighbours are friendly and we love the summer time in our garden.

GROUND FLOOR
384 sq.ft. (35.7 sq.m.) approx.

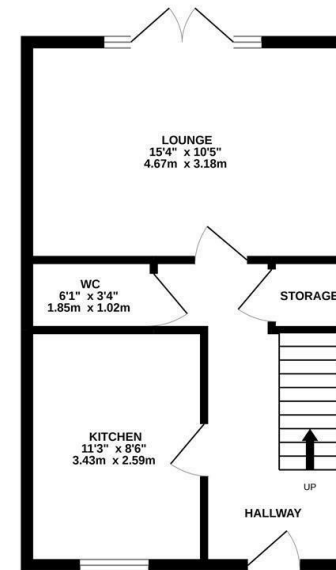

1ST FLOOR
384 sq.ft. (35.7 sq.m.) approx.

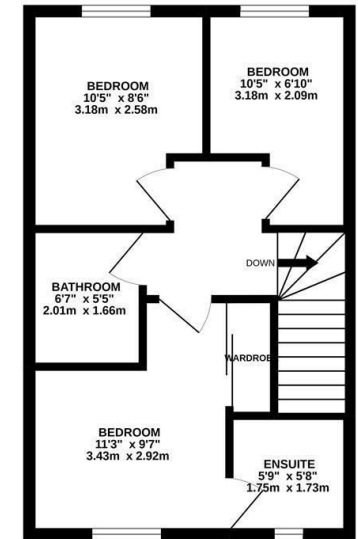

TOTAL FLOOR AREA: 768 sq.ft. (71.3 sq.m.) approx.
Whilst every attempt has been made to ensure the accuracy of the floorplan contained here, measurements of doors, windows, rooms and any other items are approximate and no responsibility is taken for any error, omission or mis-statement. This plan is for illustrative purposes only and should be used as such by any prospective purchaser. The services, systems and appliances shown have not been tested and no guarantee as to their operability or efficiency can be given.
Made with Metropix ©2022



Find us at;
45 High Street
Burton Latimer, NN15 5LB

01536 722 222
burton@oscar-james.com
www.oscar-james.com
Follow us on Facebook

Whilst every attempt has been made to ensure the accuracy of the floor plan and details contained here, measurements of doors, windows, rooms and any other items are approximate and no responsibility is taken for any error, omission, or mis-statement. This plan is for illustrative purposes only and should be used as such by any prospective purchaser. The services, systems and appliances shown have not been tested and have no guarantee as to their operability or efficiency can be given. Floor plan made with Metropix 2014. Fixtures and fittings may vary at point of sale.