

7 Lovell Court  
Irthlingborough  
Northamptonshire  
NN9 5SF

£105,000



OSCAR JAMES

...expect excellence

# FLOOR PLANS

GROUND FLOOR  
372 sq.ft. (34.6 sq.m.) approx.

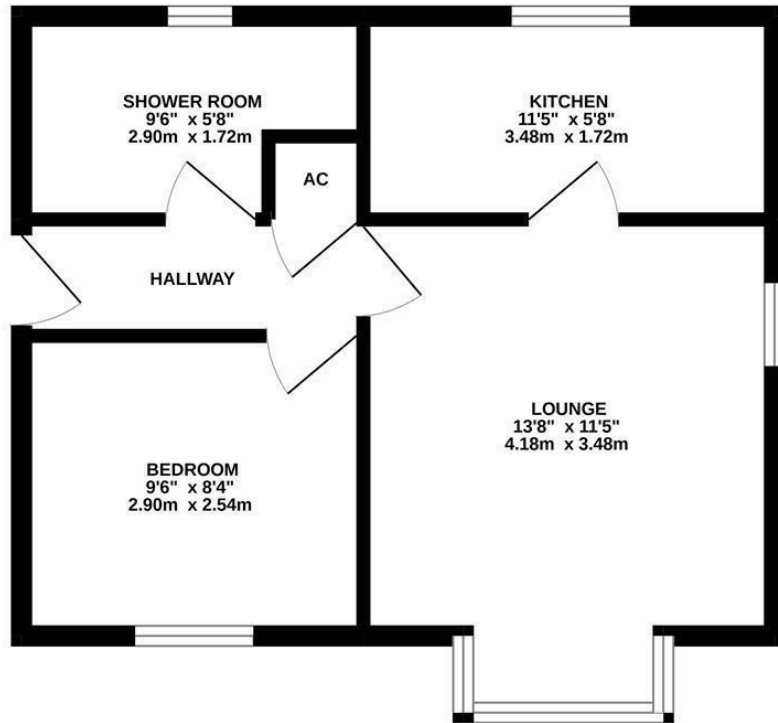

TOTAL FLOOR AREA : 372 sq.ft. (34.6 sq.m.) approx.  
Whilst every attempt has been made to ensure the accuracy of the floorplan contained here, measurements of doors, windows, rooms and any other items are approximate and no responsibility is taken for any error, omission or mis-statement. This plan is for illustrative purposes only and should be used as such by any prospective purchaser. The services, systems and appliances shown have not been tested and no guarantee is given as to their operability or efficiency can be given.  
Made with Metropix ©2022



## AT A GLANCE...



custom text 1



custom text 4



custom text 2



custom text 5



custom text 3



custom text 6



## WHAT'S GREAT?

\*\*\* 99 YEAR LEASE\*\*\* A lovely one bedroom ground floor flat situated within a block of four apartments in Irthlingborough. The property is close to the high street and local amenities, there is also great access to the A45 & A6.

Upon entering the property via the communal entrance there is a hallway giving access into the bedroom, shower room, lounge and storage cupboard. The lounge leads through to the refitted kitchen the flat is well proportioned and over looks the communal green areas.

There is an allocated parking space and also visitors spaces available

This would make the perfect investment, first time buy or downsize.

...expect excellence



# SELLER'S SECRET

This was a perfect first time buy and is within such close proximity with a short walk to the high street & local amenities.



*Why we like it....*

This Ground floor is positioned with great links to the A45 & A6. this would make a fantastic first time buy or investment property!

## OSCAR JAMES

Central Hall 1a High Street, | Wellingborough |  
NN8 4HT  
01933 830300  
[www.oscar-james.com](http://www.oscar-james.com)

*To buy or not to buy....*

---

---

---

---

---