

Knollys Meadow
Glenvale
Wellingborough
NN8 6DW

£300,000

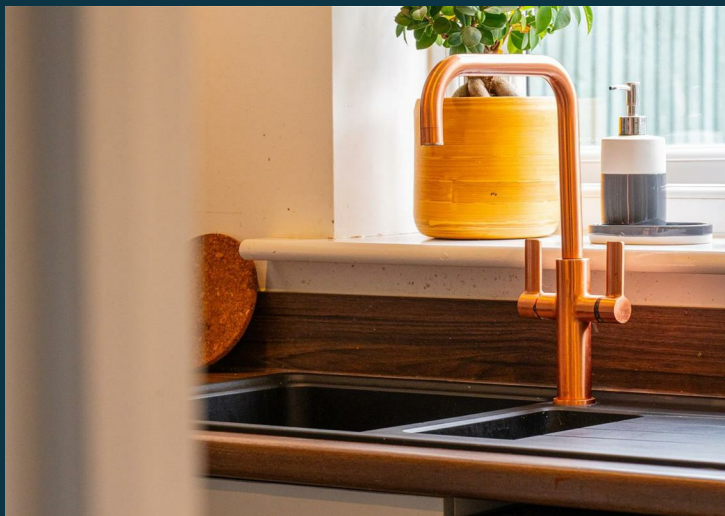

OSCAR JAMES

...expect excellence

FLOOR PLANS

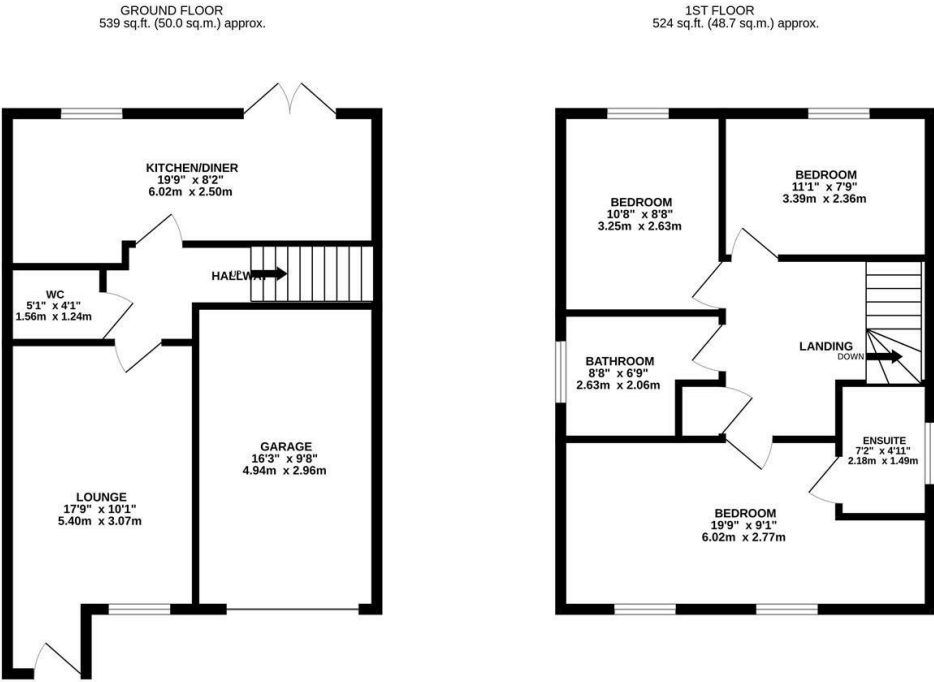

TOTAL FLOOR AREA : 1063 sq.ft. (98.7 sq.m.) approx.

Whilst every attempt has been made to ensure the accuracy of the floorplan contained here, measurements of doors, windows, rooms and any other items are approximate and no responsibility is taken for any error, omission or mis-statement. This plan is for illustrative purposes only and should be used as such by any prospective purchaser. The services, systems and appliances shown have not been tested and no guarantee as to their operability or efficiency can be given.
Made with Metropix ©2025



AT A GLANCE...



Stylish Lounge



Kitchen/Diner



Three Well Appointed Bedrooms



Cloakroom, Family Bathroom & En-Suite



Front & Rear Gardens



Off Road Parking & Garage



WHAT'S GREAT?

Nestled in the tranquil Knollys Meadow of Glenvale Park, Wellingborough, this exquisite three-bedroom detached house, built in 2022 by Persimmon Homes, showcases the elegant Dalby design. Facing a picturesque green to the front, offering a serene environment for families and professionals alike.

Upon entering, you are greeted by a welcoming entrance hall area that leads to a convenient spacious lounge providing a comfortable area for relaxation, while the impressive 19ft kitchen/dining room is ideal for entertaining guests or enjoying family meals. This modern kitchen is equipped with built-in appliances, ensuring both style and functionality. The downstairs cloakroom is designed with wheelchair access in mind.

The master bedroom is a true highlight, boasting an expansive 19ft layout and an ensuite shower room for added privacy and convenience. Two additional

well-proportioned bedrooms offer ample space for family or guests, complemented by a stylish family bathroom.

Outside, the property features charming gardens to both the front and rear, perfect for outdoor activities or simply enjoying the fresh air. A garage adds to the practicality of this home, providing secure storage or additional parking.

With uPVC double glazed doors and windows, as well as gas radiator central heating, this house promises comfort and efficiency throughout the seasons. This delightful property is an excellent opportunity for those seeking a modern home in a peaceful yet accessible location. Don't miss the chance to make this beautiful house your new home.

...expect excellence



SELLER'S SECRET

The large garden offers both sun and shade, with the patio getting the morning and lunchtime sun, and the circular patio at the top of the garden seeing sunshine late into the evening in the summer months. The sunset lights up the master bedroom, and gives a whole new definition of golden hour. The open space to the front of the property is excellent for walks, and will eventually lead onto a country park.



Why we like it....

This Detached home is almost as good as new if not better due to having the flooring and garden lawn already laid for you. Glenvale Park is now home to a School, shops, café and food outlets adding the the convenience of the area.

OSCAR JAMES

Central Hall 1a High Street, | Wellingborough |
NN8 4HT
01933 830300
www.oscar-james.com

To buy or not to buy....
