

Broad Green  
Wellingborough  
NN8 4LH

£135,000



OSCAR JAMES  
...expect excellence



# FLOOR PLANS

GROUND FLOOR  
606 sq.ft. (56.3 sq.m.) approx.

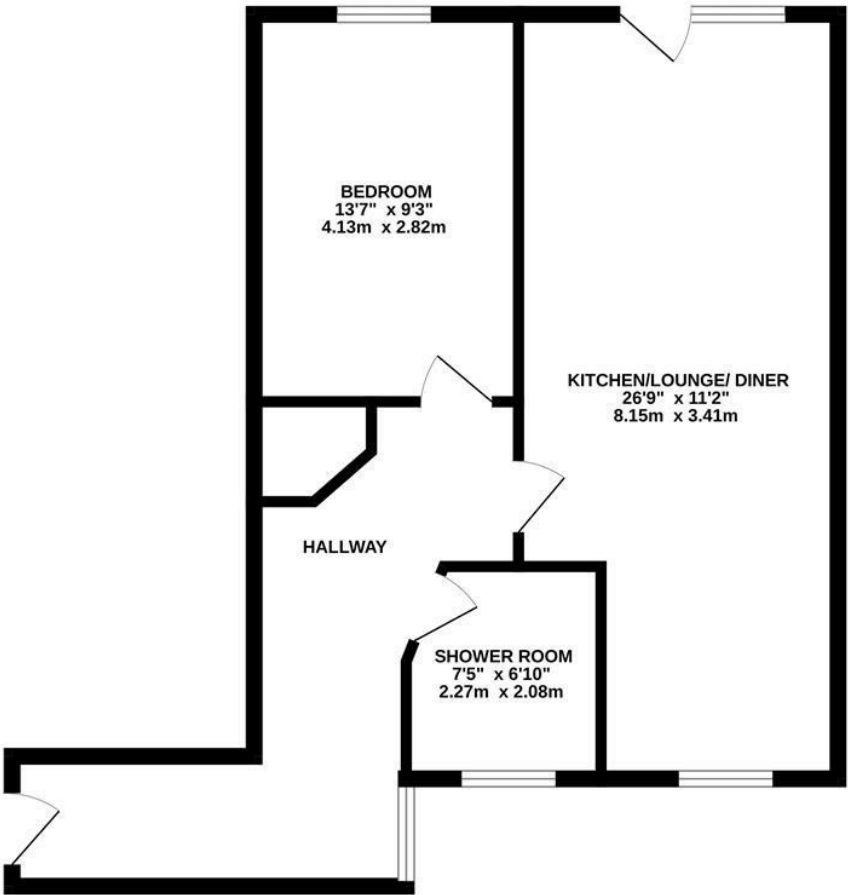

TOTAL FLOOR AREA : 606 sq.ft. (56.3 sq.m.) approx.  
Whilst every attempt has been made to ensure the accuracy of the floorplan contained here, measurements of doors, windows, rooms and any other items are approximate and no responsibility is taken for any error, omission or mis-statement. This plan is for illustrative purposes only and should be used as such by any prospective purchaser. The services, systems and appliances shown have not been tested and no guarantee as to their operability or efficiency can be given.  
Made with Metropix ©2025



## AT A GLANCE...



Open Lounge/Diner



Fitted Kitchen



Double Bedroom



Shower Room



Communal Gardens



Communal Parking





# WHAT'S GREAT?

## **\*GROUND FLOOR ACCOMMODATION\*\*NO ONWARD CHAIN\***

Nestled in the charming area of Broad Green, Wellingborough, we are pleased to introduce 'Hatton Mews', an exclusive and luxurious development tailored for those aged 55 and over. Completed in 2018 by the esteemed local builders, Seagrave Developments, this remarkable property offers a large one-bedroom ground floor apartment that is presented to the market with no upper chain.

This one bedroom ground floor apartment has been beautifully presented by the current owners and really is a must see to be appreciated property.

'Hatton Mews' comprises 30 beautifully designed apartments, thoughtfully arranged over three floors, fostering a sense of community while ensuring the privacy and comfort that residents desire. Each apartment is crafted to an exceptional standard, featuring modern amenities and the convenience of assisted

living facilities. Residents can enjoy the peace of mind provided by a 24-hour emergency call system, ensuring safety for both you and your loved ones.

Accessibility is a key feature of this development, with an internal lift available for all residents. The property also boasts a dedicated parking area and beautifully landscaped communal gardens, perfect for enjoying the outdoors and socialising with neighbours.

If you are interested in discovering more about this exceptional property within 'Hatton Mews', please do not hesitate to contact our sole selling agents, Oscar James, today. 'Hatton Mews' is not merely a place to live; it is a vibrant community designed for a fulfilling and comfortable lifestyle.

...expect excellence





# SELLER'S SECRET

We have found the property to be very energy efficient, staying cool in the summer and warm in the winter months. The real appeal for me was the proximity to all the local amenities.



## Why we like it....

Situated in Wellingborough town centre you have all the amenities on your doorstep that the town centre has to offer. With communal parking and gardens this property has a great community feel.

To buy or not to buy....

# OSCAR JAMES

Central Hall 1a High Street, | Wellingborough |  
 NN8 4HT  
 01933 830300  
[www.oscar-james.com](http://www.oscar-james.com)

---

---

---

---

---