

The Dairy
12 Cumberland Close
Northampton
NN3 2AD

£375,000



OSCAR JAMES

...expect excellence

FLOOR PLANS

GROUND FLOOR
521 sq.ft. (48.4 sq.m.) approx.

1ST FLOOR
520 sq.ft. (48.3 sq.m.) approx.

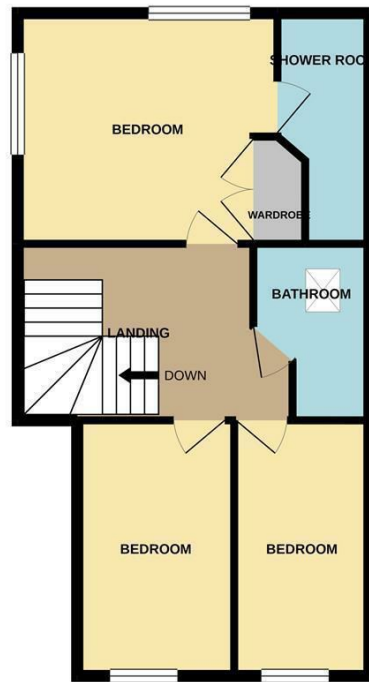
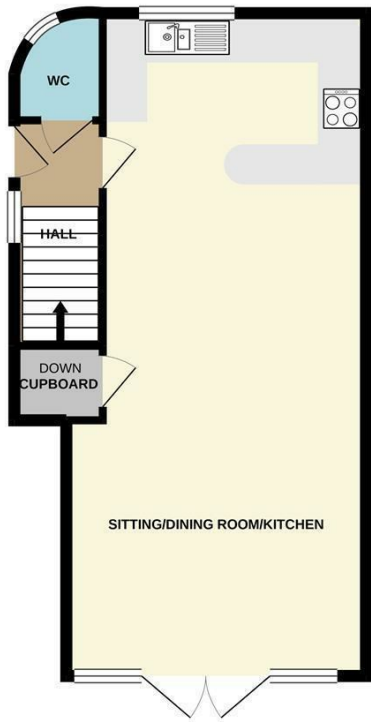

TOTAL FLOOR AREA : 1041 sq.ft. (96.7 sq.m.) approx.
Whilst every attempt has been made to ensure the accuracy of the floorplan contained here, measurements of doors, windows, rooms and any other items are approximate and no responsibility is taken for any error, omission or mis-statement. This plan is for illustrative purposes only and should be used as such by any prospective purchaser. The services, systems and appliances shown have not been tested and no guarantee as to their operability or efficiency can be given.
Made with Metrepx ©2020



AT A GLANCE...



Open plan design



Modern fitted Kitchen



Three bedrooms



En suite to master



Enclosed rear garden



Parking for two vehicles



WHAT'S GREAT?

An immaculately presented three bedroom semi-detached home forming part of an exclusive development around Home Farm House in Spinney Hill, set within a quiet residential area and offered to the market with no onward chain. Ideally located close to local supermarkets and schools.

This light and spacious property features a generous open plan kitchen/lounge/diner, perfect for modern living. The stylish fitted kitchen includes space for an American-style fridge and freezer.

Upstairs offers three well-proportioned bedrooms, with the principal bedroom benefiting from an en-suite shower room and fitted wardrobes. A contemporary family bathroom includes a shower over the bath, vanity basin, and heated towel rail.

Externally, the property provides block-paved parking for two cars, while the enclosed rear garden features a patio area leading onto a lawn, bordered by fencing and a reclaimed brick

wall.

Finished to a high standard throughout, including solid oak and veneered internal doors and TV points to all bedrooms, reception areas, and the kitchen.

...expect excellence



SELLER'S SECRET

I've always loved how much natural light fills the house throughout the day. Being in a quiet cul-de-sac makes it feel really peaceful, and the unique stonework is something that first drew me to the home



Why we like it....

Act fast to avoid disappointment—this turnkey home is set in a quiet cul-de-sac and offered with no onward chain, making it an ideal opportunity for a smooth and swift move.

OSCAR JAMES

336 Wellingborough Road | Northampton |
NN1 4ES
01604 622722
www.oscar-james.com

To buy or not to buy....
