

St. Peters Avenue
Kettering
NN16 0HB

£1,225 Per Month



OSCAR JAMES

...expect excellence

FLOOR PLANS

GROUND FLOOR
377 sq.ft. (35.0 sq.m.) approx.

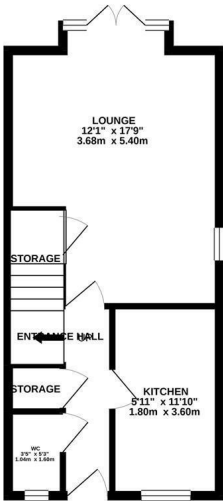

1ST FLOOR
371 sq.ft. (34.4 sq.m.) approx.

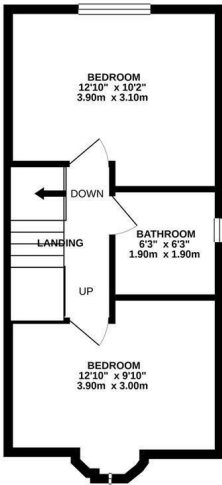

2ND FLOOR
291 sq.ft. (27.0 sq.m.) approx.

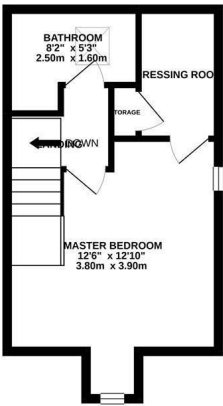

TOTAL FLOOR AREA : 1038 sq.ft. (96.5 sq.m.) approx.

Whilst every attempt has been made to ensure the accuracy of the floorplan contained here, measurements of doors, windows, rooms and any other items are approximate and no responsibility is taken for any error, omission or mis-statement. This plan is for illustrative purposes only and should be used as such by any prospective purchasers. The services, systems and appliances shown have not been tested and no guarantee as to their operability or efficiency can be given.
Made with Metropix ©2020



AT A GLANCE...



custom text 1



custom text 4



custom text 2



custom text 5



custom text 3



custom text 6



WHAT'S GREAT?

A beautiful, three bedroom town house located close to Kettering's town centre situated along a popular tree lined avenue.

Offering spacious accommodation over three floors which comprises; entrance hall, lounge diner, kitchen and ground floor WC.

On the first floor expect to find two generous bedrooms and a family bathroom.

To the second floor you will find the master suite with ensuite and dressing room.

Outside there is an enclosed rear garden, driveway and garage.

Offered to the market unfurnished, available from 18th June 2025.

EPC C
Council Tax C

...expect excellence



SELLER'S SECRET



Why we like it....

OSCAR JAMES

1 Newland Street | Kettering | NN16 8JH
01536 415777
www.oscar-james.com

To buy or not to buy....
