

Magpie Close
Corby
NN18 8FJ

£925 Per Month



OSCAR JAMES

...expect excellence

FLOOR PLANS

GROUND FLOOR
354 sq.ft. (32.9 sq.m.) approx.

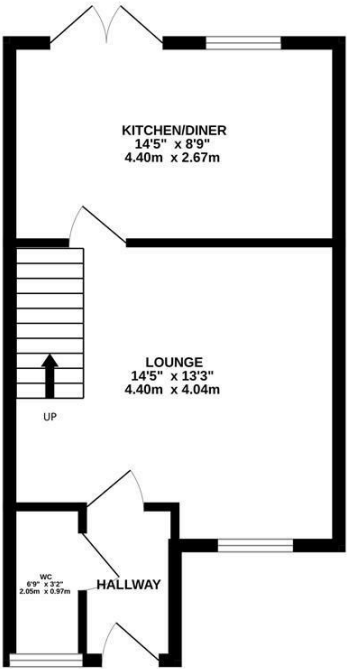

1ST FLOOR
318 sq.ft. (29.5 sq.m.) approx.

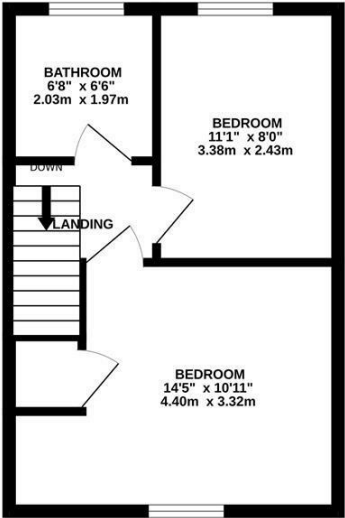

TOTAL FLOOR AREA : 672 sq.ft. (62.4 sq.m.) approx.
Whilst every attempt has been made to ensure the accuracy of the floorplans contained here, measurements of doors, windows, rooms and any other items are approximate and no responsibility is taken for any error, omission or mis-statement. This plan is for illustrative purposes only and should be used as such by any prospective purchaser. The services, systems and appliances shown have not been tested and no guarantee as to their operability or efficiency can be given.
Made with Metropix ©2026



AT A GLANCE...



custom text 1



custom text 4



custom text 2



custom text 5



custom text 3



custom text 6



WHAT'S GREAT?

Nestled in the charming area of Magpie Close, Corby, this delightful two-bedroom terraced house presents an excellent opportunity those seeking a comfortable rental. The property boasts a well-proportioned reception room, perfect for relaxing or entertaining guests.

The fitted kitchen is equipped with ample storage, making it a practical space. The bathroom is conveniently located, catering to the needs of modern living.

The two double bedrooms offer generous space, ensuring comfort and privacy for all occupants.

One of the standout features of this property is the off-road parking available at the rear, providing ease and security for your vehicle. Additionally, the location is highly advantageous, being in close proximity to local schools and shops. For those who commute, the property benefits from excellent links to major roads, ensuring a smooth journey to nearby towns and cities.

This lovely home will be available from the beginning of April, offering a perfect opportunity to settle into a new space just in time for spring. This property is sure to meet your needs with its blend of comfort, convenience, and charm. Don't miss out on the chance to make this house your home.

EPC Rating - C

...expect excellence



SELLER'S SECRET



Why we like it....

OSCAR JAMES

1 Newland Street | Kettering | NN16 8JH
01536 415777
www.oscar-james.com

To buy or not to buy....
