

The Green
Kislingbury
Northampton
NN7 4AH

£1,495 Per Month



OSCAR JAMES

...expect excellence

FLOOR PLANS

GROUND FLOOR
564 sq.ft. (52.4 sq.m.) approx.

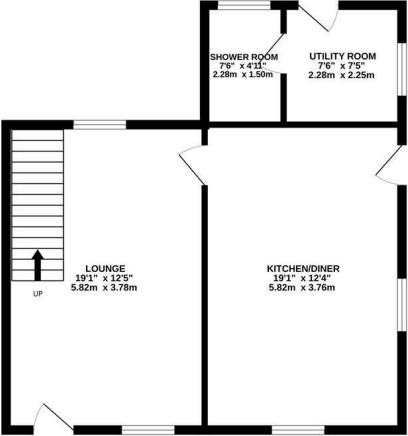

1ST FLOOR
472 sq.ft. (43.9 sq.m.) approx.

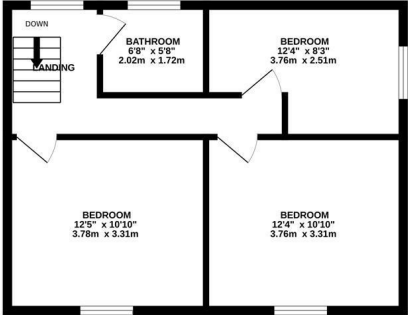

TOTAL FLOOR AREA : 1037 sq.ft. (96.3 sq.m.) approx.
Whilst every attempt has been made to ensure the accuracy of the floorplan contained here, measurements of doors, windows, rooms and any other items are approximate and no responsibility is taken for any error, omission or mis-statement. This plan is for illustrative purposes only and should be used as such by any prospective purchaser. The services, systems and appliances shown have not been tested and no guarantee as to their operability or efficiency can be given.
Made with Metropix ©2025



AT A GLANCE...



custom text 1



custom text 4



custom text 2



custom text 5



custom text 3



custom text 6



WHAT'S GREAT?

Snuggled in the picturesque village of Kislingbury, Northampton, this immaculate three-bedroom semi-detached house offers a perfect blend of modern living and charming rural surroundings. The property has been thoughtfully refurbished throughout, ensuring a fresh and inviting atmosphere for its new occupants.

Upon entering, you are greeted by a spacious reception room that provides a warm and welcoming space for relaxation and entertaining. The heart of the home is undoubtedly the large family kitchen, which is designed for both functionality and style. Adjacent to the kitchen, a separate utility room adds convenience, making daily chores a breeze.

The property boasts three well-proportioned bedrooms, providing ample space for family living or guests. With two modern bathrooms, morning routines will be a pleasure rather than a rush.

Outside, the good-sized landscaped garden offers a delightful retreat, perfect for enjoying the

fresh air or hosting summer gatherings. The scenic location of Kislingbury not only enhances the property's appeal but also provides excellent commuting options, making it ideal for those who work in nearby towns or cities.

This stunning home is available immediately and is sure to attract considerable interest. With its desirable features and prime location, it will not be on the market for long. Do not miss the opportunity to make this beautiful house your new home.
EPC Rating - D

...expect excellence



SELLER'S SECRET



Why we like it....

OSCAR JAMES

1 Newland Street | Kettering | NN16 8JH
01536 415777
www.oscar-james.com

To buy or not to buy....
