

Broom Way  
Kettering  
NN15 7RB

£1,750 Per Month



OSCAR JAMES

...expect excellence



# FLOOR PLANS

GROUND FLOOR  
833 sq.ft. (77.4 sq.m.) approx.

1ST FLOOR  
604 sq.ft. (56.1 sq.m.) approx.

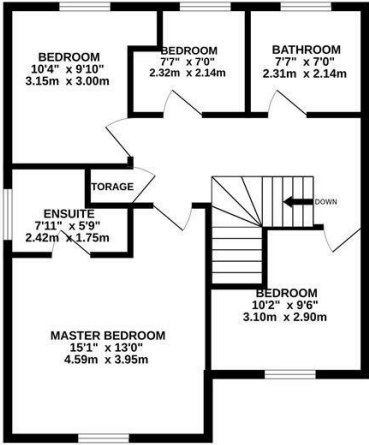
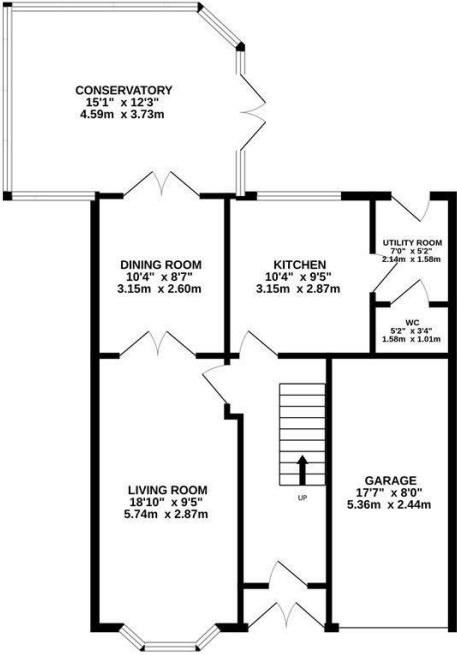

TOTAL FLOOR AREA : 1437 sq.ft. (133.5 sq.m.) approx.

Whilst every attempt has been made to ensure the accuracy of the floorplan contained here, measurements of doors, windows, rooms and any other items are approximate and no responsibility is taken for any error, omission or mis-statement. This plan is for illustrative purposes only and should be used as such by any prospective purchaser. The services, systems and appliances shown have not been tested and no guarantee as to their operability or efficiency can be given.

Made with Metreplex 10/2024



## AT A GLANCE...



custom text 1



custom text 4



custom text 2



custom text 5



custom text 3



custom text 6



# WHAT'S GREAT?

Large four bedroom family home located on the Leisure village development in Kettering.  
Close to schools and local amenities.

The property briefly comprises hallway leading to lounge diner with doors to the large conservatory.

Fitted kitchen with utility room and downstairs W.C

To the first floor are four bedrooms, family bathroom and en-suite shower room to the master

Fully enclosed rear garden with patio area and mature trees keeping the garden private.

The property boasts an integral garage and over driveway for up to 4 vehicles.

\*\*\* AVAILABLE MARCH \*\*\*

EPC D  
Council tax E

...expect excellence





# SELLER'S SECRET



Why we like it....

OSCAR JAMES

1 Newland Street | Kettering | NN16 8JH  
01536 415777  
[www.oscar-james.com](http://www.oscar-james.com)

To buy or not to buy....

---

---

---

---

---