

St. Johns Road  
Kettering  
NN15 5AZ

£1,195 Per Month



OSCAR JAMES

...expect excellence

# FLOOR PLANS

GROUND FLOOR  
418 sq.ft. (38.8 sq.m.) approx.

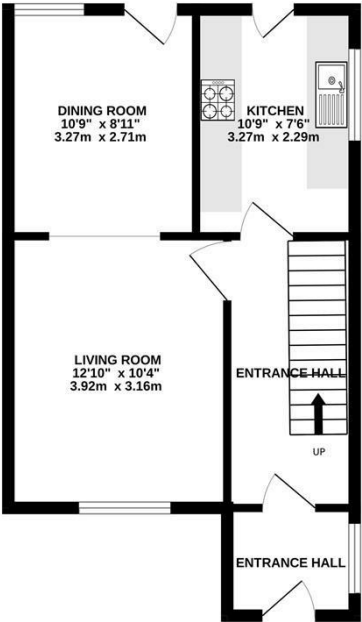

1ST FLOOR  
385 sq.ft. (35.8 sq.m.) approx.

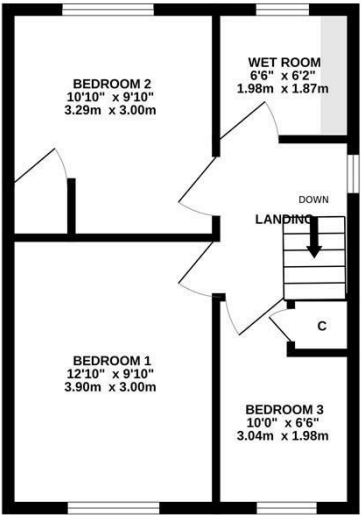

TOTAL FLOOR AREA : 803 sq.ft. (74.6 sq.m.) approx.

Whilst every attempt has been made to ensure the accuracy of the floorplan contained here, measurements of doors, windows, rooms and any other items are approximate and no responsibility is taken for any error, omission or mis-statement. This plan is for illustrative purposes only and should be used as such by any prospective purchaser. The services, systems and appliances shown have not been tested and no guarantee as to their operability or efficiency can be given.

Made with Meepex 12/2025



## AT A GLANCE...



custom text 1



custom text 4



custom text 2



custom text 5



custom text 3



custom text 6



## WHAT'S GREAT?

A generous sized three bedroomed semi detached property situated on the popular Ise lodge estate.

The ground floor comprises of a large open plan lounge / dining room with feature fire place. The kitchen offers ample base and eye level units and space for white goods.

To the first floor there are three bedrooms, two of which are double in size and one single bedroom.

The property benefits from an accessible wet room on this floor which provides W/C, basin and open shower.

The rear garden has an enclosed patio area leading through to a large lawn area with access to the garage to the side

The property offers off road parking for 3/4 vehicles.

Offered to the market unfurnished and available NOW

Close to nurseries, primary and secondary schools

Local amenities within easy walking distance.

EPC D

Council tax band B

...expect excellence



# SELLER'S SECRET



Why we like it....

OSCAR JAMES

1 Newland Street | Kettering | NN16 8JH  
01536 415777  
[www.oscar-james.com](http://www.oscar-james.com)

To buy or not to buy....

---

---

---

---

---