

St. Crispin Road  
Earls Barton  
NN6 0PG

£2,900



OSCAR JAMES

...expect excellence



# FLOOR PLANS

GROUND FLOOR  
1309 sq.ft. (121.6 sq.m.) approx.

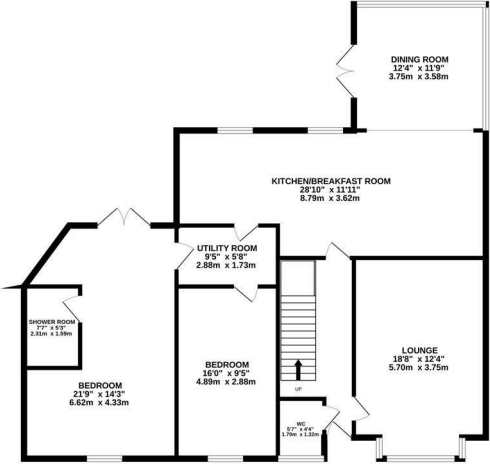

1ST FLOOR  
950 sq.ft. (88.2 sq.m.) approx.

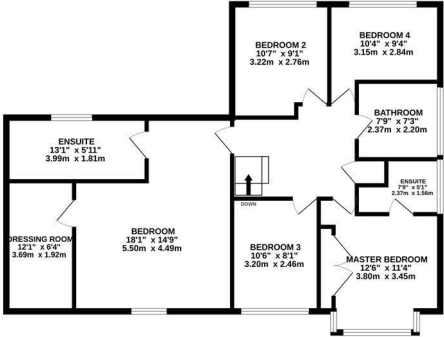

TOTAL FLOOR AREA: 2259 sq.ft. (209.8 sq.m.) approx.  
Whilst every attempt has been made to ensure the accuracy of the floorplan contained here, measurements of doors, windows, rooms and any other items are approximate and no responsibility is taken for any error, omission or mis-statement. This plan is for illustrative purposes only and should be used as such by any prospective purchaser. The services, systems and appliances shown have not been tested and no guarantee as to their operability or efficiency can be given.  
Made with Metropix 12025



## AT A GLANCE...



custom text 1



custom text 4



custom text 2



custom text 5



custom text 3



custom text 6



# WHAT'S GREAT?

\*\*\*AVAILABLE MID AUGUST\*\*\*

Nestled on the desirable St. Crispin Road in Earls Barton, this impressive recently converted detached house offers a perfect blend of space and modern living. Spanning an expansive 2,259 square feet, the property boasts six generously sized bedrooms, making it an ideal family home.

Upon entering, you are greeted by three well-appointed reception rooms, providing ample space for relaxation and entertainment. The heart of the home is undoubtedly the open plan kitchen and dining area, which creates a warm and inviting atmosphere for family gatherings and social occasions. This contemporary layout not only enhances the flow of the living space but also allows for easy interaction between family and guests.

With four bathrooms, including en-suite facilities, this property ensures convenience and comfort for all residents. Built in 1994, the house combines modern design with practical

features, making it a wonderful choice for those seeking a home that meets the demands of contemporary life.

The location in Earls Barton is highly sought after, offering a friendly community atmosphere while still being within easy reach of local amenities and transport links. This property is a rare find, providing both space and style in a tranquil setting. Whether you are looking to settle down with your family or seeking a spacious home for entertaining, this house on St. Crispin Road is sure to impress.

The property is currently undergoing redecoration.

\*\*\*AVAILABLE MID AUGUST\*\*\*

Please contact Oscar James for further information or to book a viewing.

Council Tax Band: E  
EPC: C

...expect excellence





# SELLER'S SECRET



Why we like it....

OSCAR JAMES

1 Newland Street | Kettering | NN16 8JH  
01536 415777  
[www.oscar-james.com](http://www.oscar-james.com)

To buy or not to buy....

---

---

---

---

---