

Rectory Lane
Orlingbury
Kettering
NN14 1JH

£895 Per Month



OSCAR JAMES

...expect excellence

FLOOR PLANS

GROUND FLOOR
308 sq.ft. (28.6 sq.m.) approx.

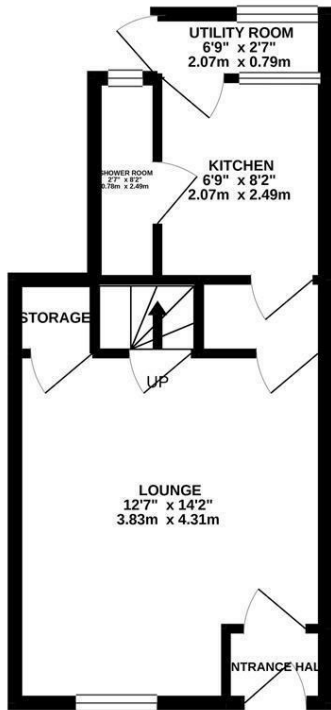

1ST FLOOR
207 sq.ft. (19.2 sq.m.) approx.

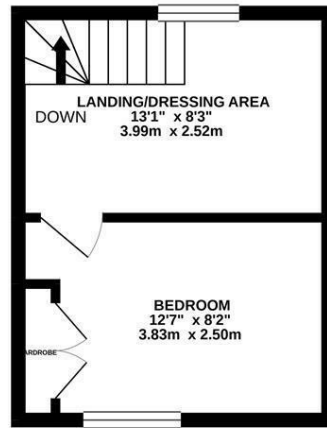

TOTAL FLOOR AREA : 515 sq.ft. (47.8 sq.m.) approx.

Whilst every attempt has been made to ensure the accuracy of the floorplan contained here, measurements of doors, windows, rooms and any other items are approximate and no responsibility is taken for any error, omission or mis-statement. This plan is for illustrative purposes only and should be used as such by any prospective purchaser. The services, systems and appliances shown have not been tested and no guarantee is given as to their operability or efficiency can be given.
Made with Metrepx ©2021



AT A GLANCE...



custom text 1



custom text 4



custom text 2



custom text 5



custom text 3



custom text 6



WHAT'S GREAT?

STUNNING one bedroom cottage for rent in the idyllic village of Orlingbury.
This beautiful, stone built, mid terraced cottage MUST BE SEEN

The property briefly comprises entrance porch, lounge with multi fuel burner, kitchen with washing machine and fridge freezer, shower room, a good sized bedroom and large dressing area or ideal place for a home office.

The rear garden is fully enclosed and low maintenance but the perfect sun trap!

- One bedroom with a large dressing area
- Stone mid-terrace
- Quiet village location
- Well located
- Multifuel burner in the lounge

*** AVAILABLE NOW ***

Council Tax Band: B
EPC: D

...expect excellence



SELLER'S SECRET



Why we like it....

OSCAR JAMES

1 Newland Street | Kettering | NN16 8JH
01536 415777
www.oscar-james.com

To buy or not to buy....
