

Flat 7 Church's Factory
10 Duke Street
Northampton
Northamptonshire
NN1 3BA

£1,200 Per Month



OSCAR JAMES

...expect excellence

FLOOR PLANS

GROUND FLOOR
857 sq.ft. (79.6 sq.m.) approx.

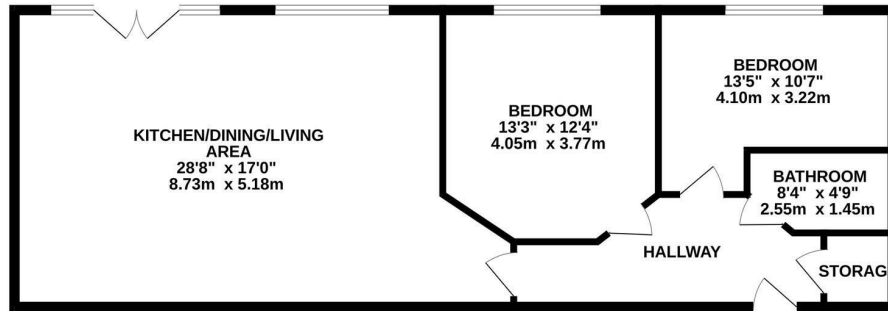

TOTAL FLOOR AREA: 857 sq.ft. (79.6 sq.m.) approx.
Whilst every attempt has been made to ensure the accuracy of the floorplan contained here, measurements of doors, windows, rooms and any other items are approximate and no responsibility is taken for any error, omission or mis-statement. This plan is for illustrative purposes only and should be used as such by any prospective purchaser. The services, systems and appliances shown have not been tested and no guarantee as to their operability or efficiency can be given.
Made with Metropix ©2023



AT A GLANCE...



Stunning open plan
lounge/diner/modern fitted kitchen



Modern fitted kitchen



2 double bedrooms



Modern fitted bathroom with
shower over bath



Juliette balcony



Security entry system and secure
underground parking for 1 car



WHAT'S GREAT?

Oscar James are delighted to offer for rent this superb first floor apartment in this modern factory conversion, located within walking distance to the town centre. The property boasts some superb features such as exposed brickwork and wooden beams amongst many others.

Council Tax Band: D
EPC Rating- C

The internal accommodation comprises of a large entrance hall with storage cupboard, stunning open plan lounge/diner/modern fitted kitchen with Juliette balcony, two good sized double bedrooms and a modern fitted bathroom with shower over bath.

Further benefits of this great apartment are double glazing throughout, security entry system and secure underground parking for 1 car.

To view this great property, call Oscar James today!

*** AVAILABLE EARLY AUGUST ***

...expect excellence



SELLER'S SECRET



Why we like it....

OSCAR JAMES

1 Newland Street | Kettering | NN16 8JH
01536 415777
www.oscar-james.com

To buy or not to buy....
