

Flat 3 Pegasus Court
Leicester Road
Market Harborough
LE16 7AP

£180,000



OSCAR JAMES

...expect excellence

FLOOR PLANS

GROUND FLOOR

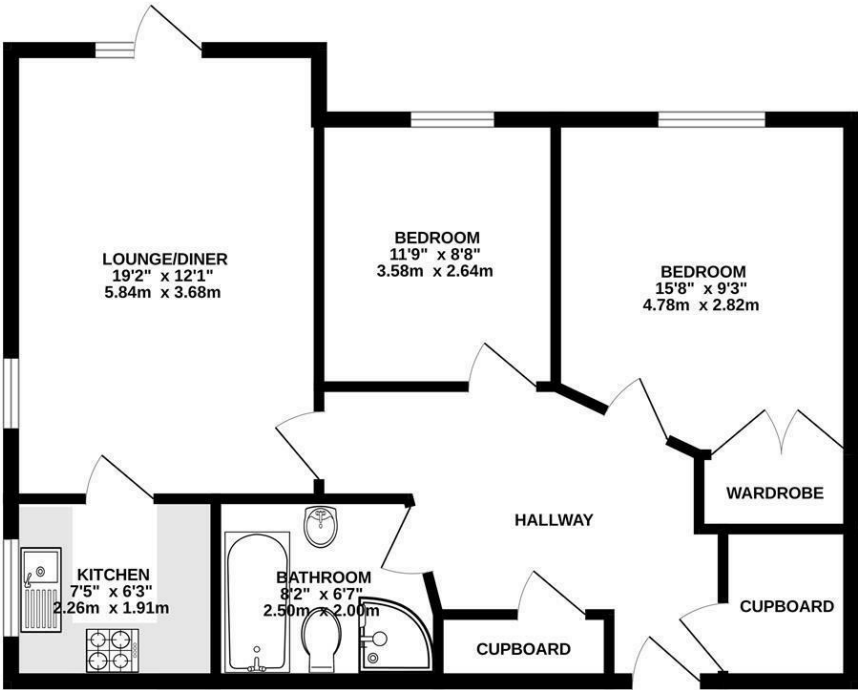

TOTAL FLOOR AREA: 670 sq.ft. (62.3 sq.m.) approx.
Whilst every attempt has been made to ensure the accuracy of the floorplan contained here, measurements of doors, windows, rooms and any other items are approximate and no responsibility is taken for any error, omission or mis-statement. This plan is for illustrative purposes only and should be used as such by any prospective purchaser. The services, systems and appliances shown have not been tested and no guarantee as to their operability or efficiency can be given.
Made with Metropix ©2024



AT A GLANCE...



Homely, yet spacious lounge space



Fitted kitchen complete with oven, microwave and fridge/freezer



Two generously sized double bedrooms



Bathroom which includes separate shower cubicle



Designated private garden area and additional communal garden



Ample parking spaces on a first come first served basis



WHAT'S GREAT?

This superb ground floor retirement apartment is available with no chain and is situated within walking distance of the town centre, railway station and local amenities. Located within Pegasus Court for the over 55's, the apartment offers a welcoming environment and benefits from an on-site manager, a communal lounge with kitchen area, a gymnasium, a laundry room, and a twin-room guest suite for visitors.

The property

Access is gained via the communal hallways and leads to the apartment. There is a spacious inner hallway to the apartment with storage cupboards and access to a well proportioned living/dining room boasting patio door leading out to a paved patio area and feature fireplace, modern fitted kitchen with a range of built in appliances, two double bedrooms with the principle bedroom featuring built in wardrobes and bedroom two also offering great bedroom space or an additional reception room, modern bathroom with a four piece suite including shower cubicle.

Outside

Pegasus court offers a number of parking spaces on a first come first served basis and well maintained communal gardens wrapping around the development

Miscellaneous

The property is on a leasehold tenure for 125 years from 1st January 2007 and includes a service charge of £5,289 per annum with an additional ground rent of £779 per annum.

...expect excellence



SELLER'S SECRET

Perfectly located close to town, and with such friendly and welcoming residents.



Why we like it....

Generously sized retirement apartment situated in Market Harborough Town centre, with a multitude of local amenities.

OSCAR JAMES

7 St Marys Road | Market Harborough | LE16
7DS

01858 458 458

www.oscar-james.com

To buy or not to buy....
